







ART. 201 Raccordo diritto maschio conico
Taper straight male adaptor

CODICE	ØD	A	B	L			
2010418	4	G1/8	8,0	27,0	10	11	100
2010618	6	G1/8	8,0	28,0	12	11	100
2010614	6	G1/4	11,0	31,5	12	14	100
2010818	8	G1/8	8,0	29,5	14	12	100
2010814	8	G1/4	11,0	33,0	14	14	100
2010838	8	G3/8	11,0	34,0	14	17	50
2011014	10	G1/4	11,0	33,0	19	16	50
2011038	10	G3/8	11,5	38,0	19	17	50
2011012	10	G1/2	14,0	36,5	19	22	25
2011238	12	G3/8	11,5	33,5	22	19	25
2011212	12	G1/2	14,0	36,5	22	22	25
2011412	14	G1/2	14,0	40,0	22	22	25
2011512	15	G1/2	14,0	41,0	24	22	25
2011612	16	G1/2	14,0	45,0	30	24	10
2011812	18	G1/2	14,0	45,0	32	26	10

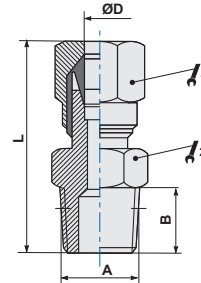

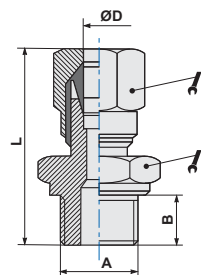

ART. 201Z Raccordo diritto maschio cilindrico
Parallel straight male adaptor

CODICE	ØD	A	B	L			
201Z0418	4	G1/8	6	25,0	10	14	100
201Z0618	6	G1/8	6	26,0	12	14	100
201Z0818	8	G1/8	6	27,5	14	14	100
201Z0814	8	G1/4	8	30,0	14	17	50
201Z1014	10	G1/4	8	34,5	19	17	50





ART. 202 Raccordo diritto femmina
Female straight adaptor

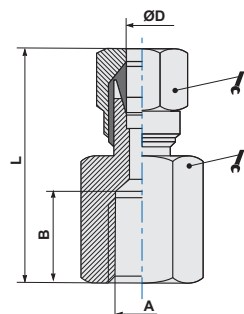

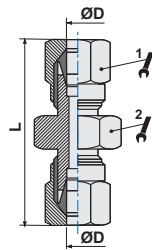
CODICE	ØD	A	B	L			
2020418	4	G1/8	8,0	24,5	10	14	100
2020618	6	G1/8	8,0	26,0	12	14	100
2020614	6	G1/4	11,0	30,5	12	17	100
2020818	8	G1/8	8,0	26,5	14	14	100
2020814	8	G1/4	11,0	31,0	14	17	100
2020838	8	G3/8	11,5	31,0	14	20	50
2021014	10	G1/4	11,0	13,5	19	17	50
2021038	10	G3/8	11,5	36,5	19	20	50





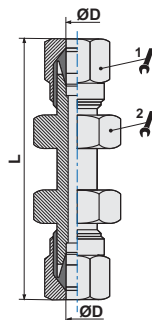

ART. 203
Raccordo diritto intermedio
Straight connector

CODICE	ØD	L					
2030400	4	35,0			10	10	50
2030600	6	36,5			12	12	50
2030800	8	38,5			12	12	50
2031000	10	47,5			19	17	25
2031200	12	50,5			22	19	25
2031400	14	55,5			27	24	10
2031500	15	55,5			27	24	10

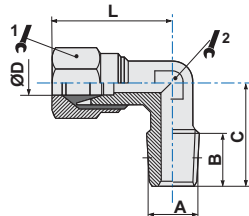
ART. 204
Raccordo passaparete
Bulkhead adaptor



CODICE	ØD	L					
2040600	6	48,0			12	14	50
2040800	8	55,0			14	17	50
2041000	10	58,0			19	19	25
2041200	12	66,0			19	19	10
2041500	15	69,5			27	25	5



ART. 205
Raccordo ad L
Elbow male adaptor

CODICE	ØD	A	B	C	L				
2050418	4	G1/8	7,5	16,0	21,0		10	9	100
2050618	6	G1/8	7,5	16,0	23,0		12	10	100
2050614	6	G1/4	11,0	20,0	24,5		12	11	100
2050818	8	G1/8	7,5	17,0	24,0		14	11	100
2050814	8	G1/4	11,0	20,0	24,0		14	11	100
2050838	8	G3/8	11,0	26,5	32,5		14	14	50
2051014	10	G1/4	11,0	23,5	32,0		19	13	50
2051038	10	G3/8	11,5	24,0	32,0		19	13	50
2051012	10	G1/2	14,0	30,0	33,0		17	17	25
2051238	12	G3/8	11,0	26,5	33,0		19	14	25
2051212	12	G1/2	14,0	30,0	33,0		19	17	25
2051412	14	G1/2	14,0	30,0	39,0		22	17	25
2051512	15	G1/2	14,0	30,0	37,0		24	17	10
2051612	16	G1/2	14,0	31,5	39,5		30	19	10
2051812	18	G1/2	14,0	34,0	44,0		32	22	10

ART. 206

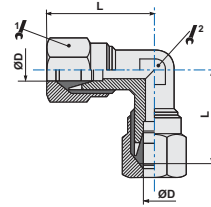

Raccordo ad L intermedio
Elbow connector

CODICE	ØD	L							
2060400	4	27,0					10	11	100
2060600	6	28,0					12	11	50
2060800	8	28,5					14	11	50
2061000	10	32,0					17	14	25
2061200	12	35,0					19	13	10
2061400	14	39,0					22	17	10
2061500	15	40,0					27	17	10



ART. 207

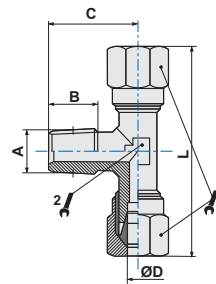

Raccordo a T centrale
Centre male tee adaptor

CODICE	ØD	A	B	C	L				
2070418	4	G1/8	8,0	16,0	42		10	9	100
2070618	6	G1/8	8,0	16,0	46		12	9	50
2070614	6	G1/4	11,0	20,0	48		12	11	50
2070818	8	G1/8	8,0	17,0	48		14	11	50
2070814	8	G1/4	11,0	20,0	48		14	11	25
2070838	8	G3/8	11,5	24,0	54		14	13	25
2071014	10	G1/4	11,0	23,5	64		19	13	25
2071038	10	G3/8	11,5	24,0	64		19	13	25
2071238	12	G3/8	11,5	25,5	69		22	15	10
2071212	12	G1/2	14,0	28,5	69		22	15	10



ART. 208

Raccordo a T laterale
Off-set male tee adaptor

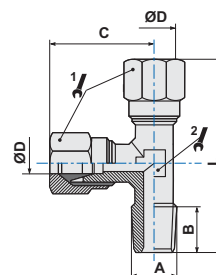

CODICE	ØD	A	B	C	L				
2080418	4	G1/8	8	22,5	38,5		10	9	100
2080618	6	G1/8	8	23,5	39,5		12	9	100
2080614	6	G1/4	11	25,0	45,0		12	10	50
2080818	8	G1/8	8	26,5	46,5		14	12	50
2080814	8	G1/4	11	28,0	47,5		14	10	25
2080838	8	G3/8	11	34,5	58,5		14	13	25
2081014	10	G1/4	11	30,0	53,0		17	12	25
2081038	10	G3/8	11	34,0	60,0		17	13	25
2081238	12	G3/8	11	34,0	60,0		19	13	10
2081212	12	G1/2	14	36,0	64,0		19	17	10

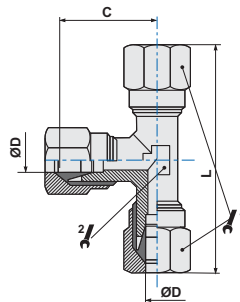



ART. 209

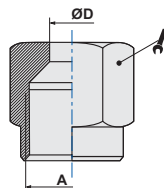

Raccordo a T intermedio
Tee connector

CODICE	ØD	C	L					
2090400	4	21	42			10	9	50
2090600	6	23	46			12	10	50
2090800	8	24	48			14	10	25
2091000	10	30	60			17	12	25
2091200	12	34	68			19	13	10



ART. 210

Dado
Nut

CODICE	ØD	A					
2100400	4	M8x1				10	100
2100600	6	M10x1				12	100
2100800	8	M12x1				14	100
2101000	10	M16x1,5				19	100
2101200	12	M18x1,5				22	100
2101400	14	M22x1,5				27	50
2101500	15	M22x1,5				27	50
2101600	16	M24x1,5				30	10
2101800	18	M26x1,5				32	10

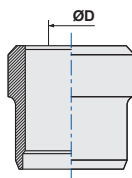

ART. 211

Ogiva
Ogive

CODICE	ØD					
2110400	4					100
2110600	6					100
2110800	8					100
2111000	10					100
2111200	12					100
2111400	14					100
2111500	15					100
2111600	16					100

ART. 212 Boccia di supporto
Support bush

CODICE	ØD						
2120200	2,0						100
2120250	2,5						100
2120400	4,0						100
2120600	6,0						100
2120800	8,0						100
2121000	10,0						100
2121200	12,0						100

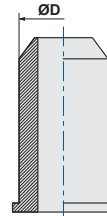

ART. 216 Raccordo ad L orientabile
Single banjo body

CODICE	ØD	G*	ØA	B	L		
2160418	4	1/8	9,8	14,5	24,5	10	50
2160618	6	1/8	9,8	14,5	26,5	12	50
2160614	6	1/4	13,2	14,5	28,5	12	50
2160818	8	1/8	9,8	14,5	25,5	14	50
2160814	8	1/4	13,2	14,5	28,0	14	50
2161014	10	1/4	13,3	14,5	32,0	17	25

(*) G = filetto vite/asta
(*) G = steam thread

