

Caratteristiche funzionali

Tensione di alimentazione	24 VDC ± 10% PNP
Assorbimento elettropiloti	4,6 Watt
Pressione di lavoro	2 ± 8 bar
Temperatura di impiego	-5°C +50°C
Grado di protezione	IP 65
Fluido	Aria filtrata e lubrificata o non (se lubrificata la lubrificazione deve essere continua)

Attenzione : Per applicazioni a basse temperature l'aria deve essere opportunamente essiccata

Sequenza di montaggio

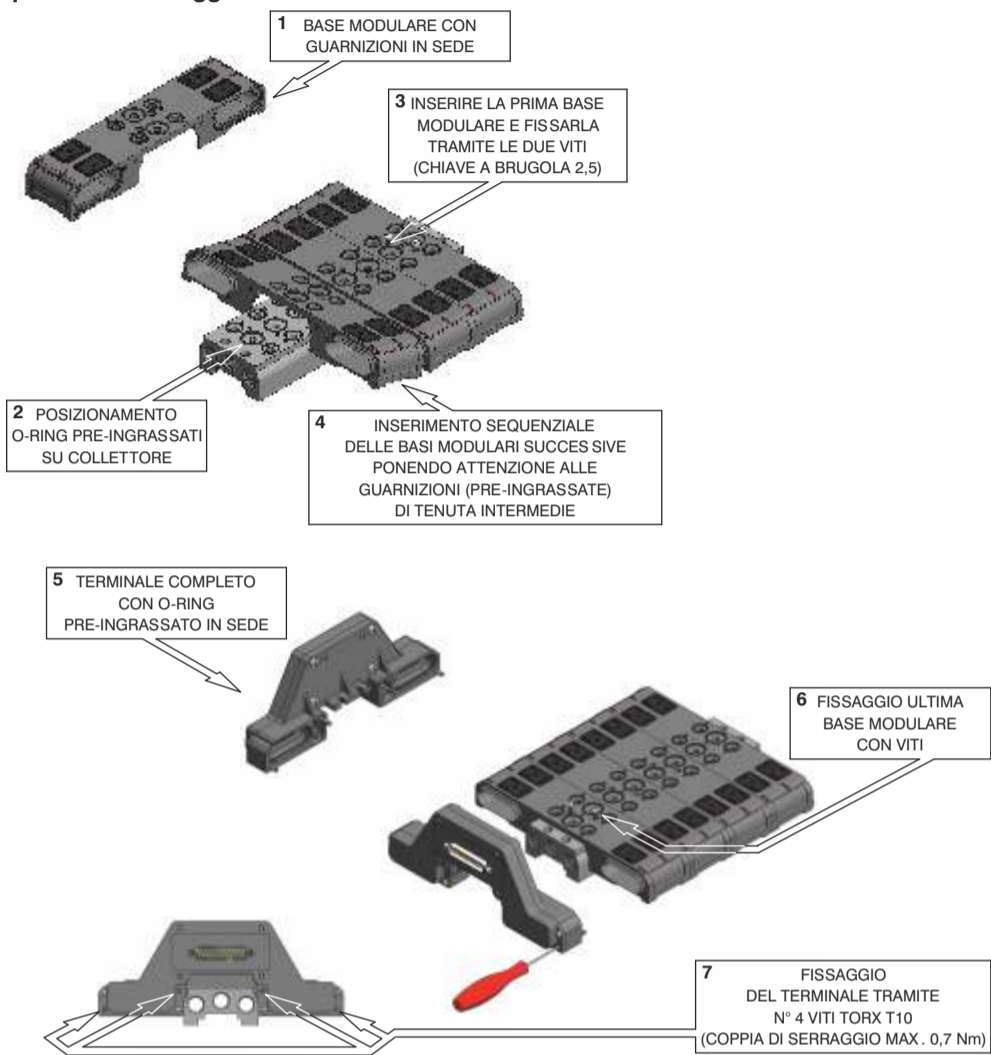

Fissaggi

Fissaggio dall'alto

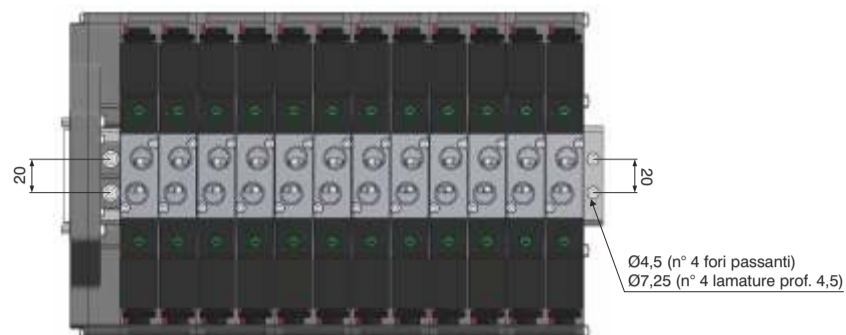

Fissaggio su guida DIN

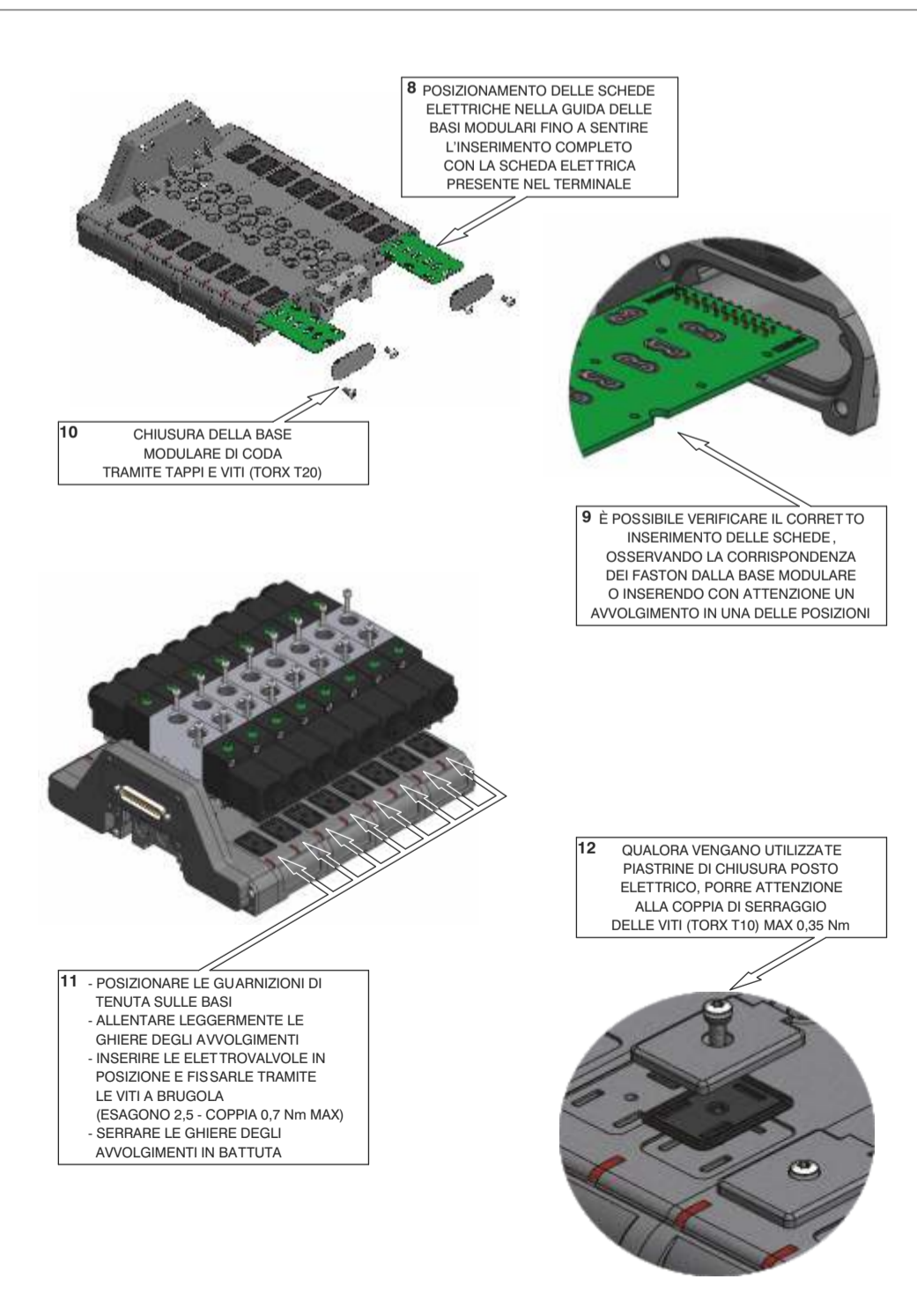
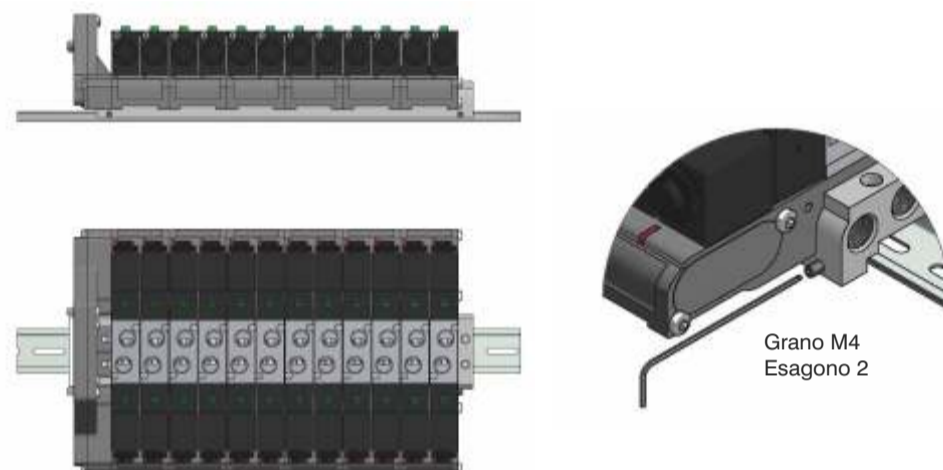

Connessione elettrica

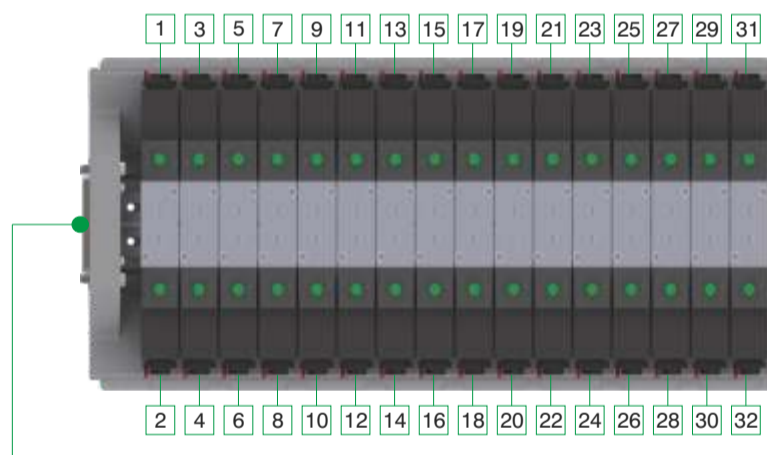

Connettore 25 Poli da 1 a 11 Posti E.V. Bistabili / Monostabili

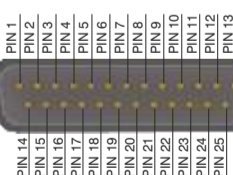

1 - 22 = SEGNALI
23 - 24 = COMUNE
25 = NC

Connettore 37 Poli da 1 a 16 Posti E.V. Bistabili / Monostabili

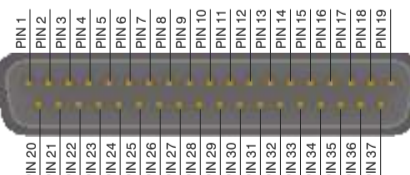

1 - 32 = SEGNALI
33 - 35 = COMUNE
36 - 37 = NC

La connessione elettrica è realizzata tramite un connettore maschio SUB-D a 37 poli che consente di gestire fino a 32 segnali elettrici.

E' inoltre disponibile un a versione con connettore maschio SUB-D a 25 poli che consente di gestire fino a 22 segnali elettrici.

Le valvole 5/2 bistabili e 5/3 richiedono sempre 2 segnali elettrici essendo dotate di 2 elettropiloti. Le valvole 5/2 monostabili richiedono un singolo segnale elettrico essendo dotate del solo pilota.

Il numero massimo di EV che possono comporre la batteria sono con:

- Connettore ingresso 37P = MAX 16 Bistabili
- Connettore ingresso 25P = MAX 11 Bistabili

Technical characteristics

Voltage	24 VDC ± 10% PNP
Power consumption	4,6 Watt
Working pressure	2 ± 8 bar
Operating temperature	-5°C +50°C
Protection degree	IP 65
Fluid	Filtered and lubricated air or not (if lubricated air, the lubrication must be continuous)

Attention: dry air must be used for applications below 0°C

Assembly sequence

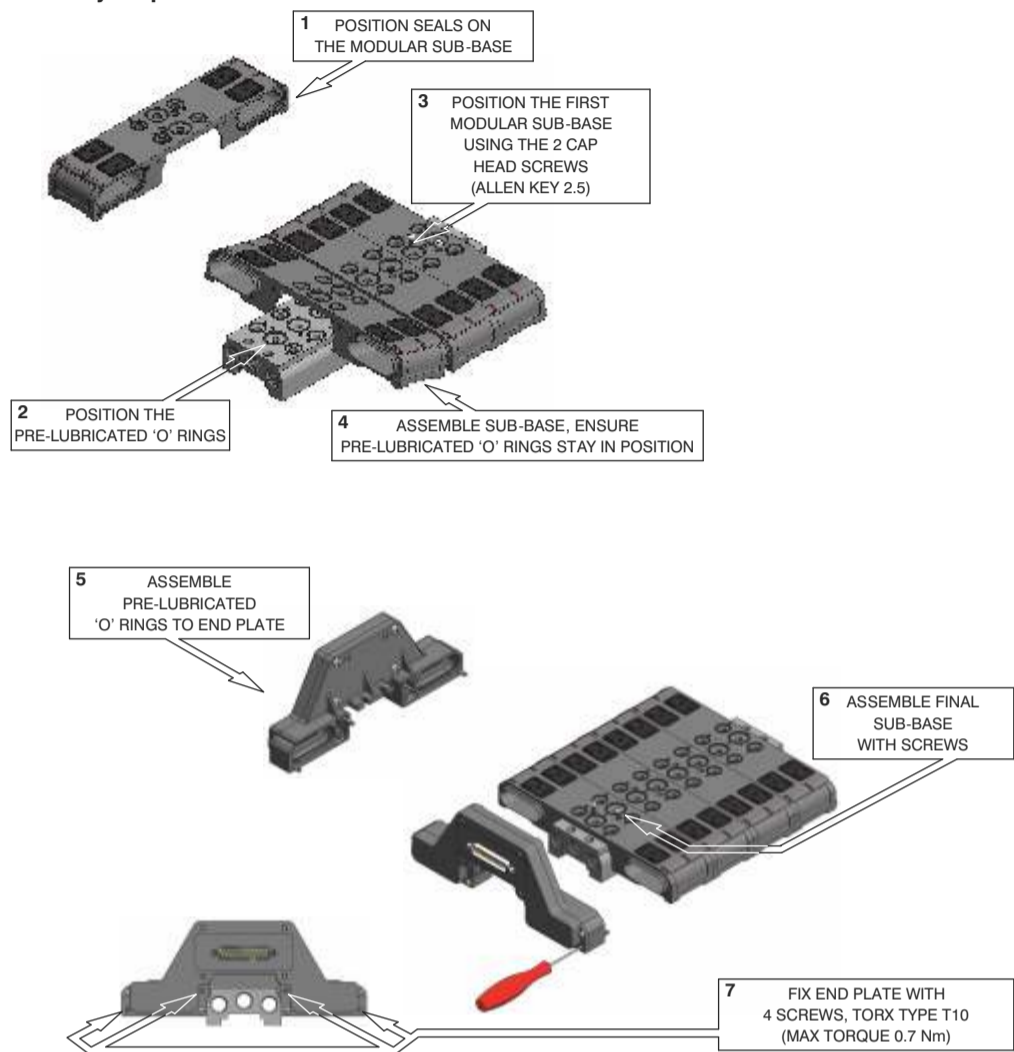

Fastening

Top fastening

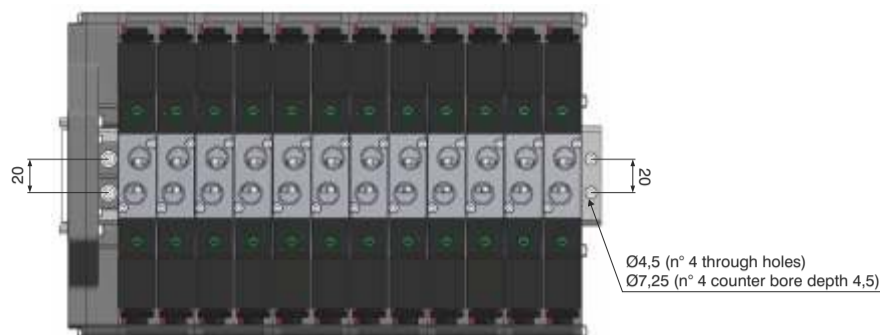

DIN rail fastening

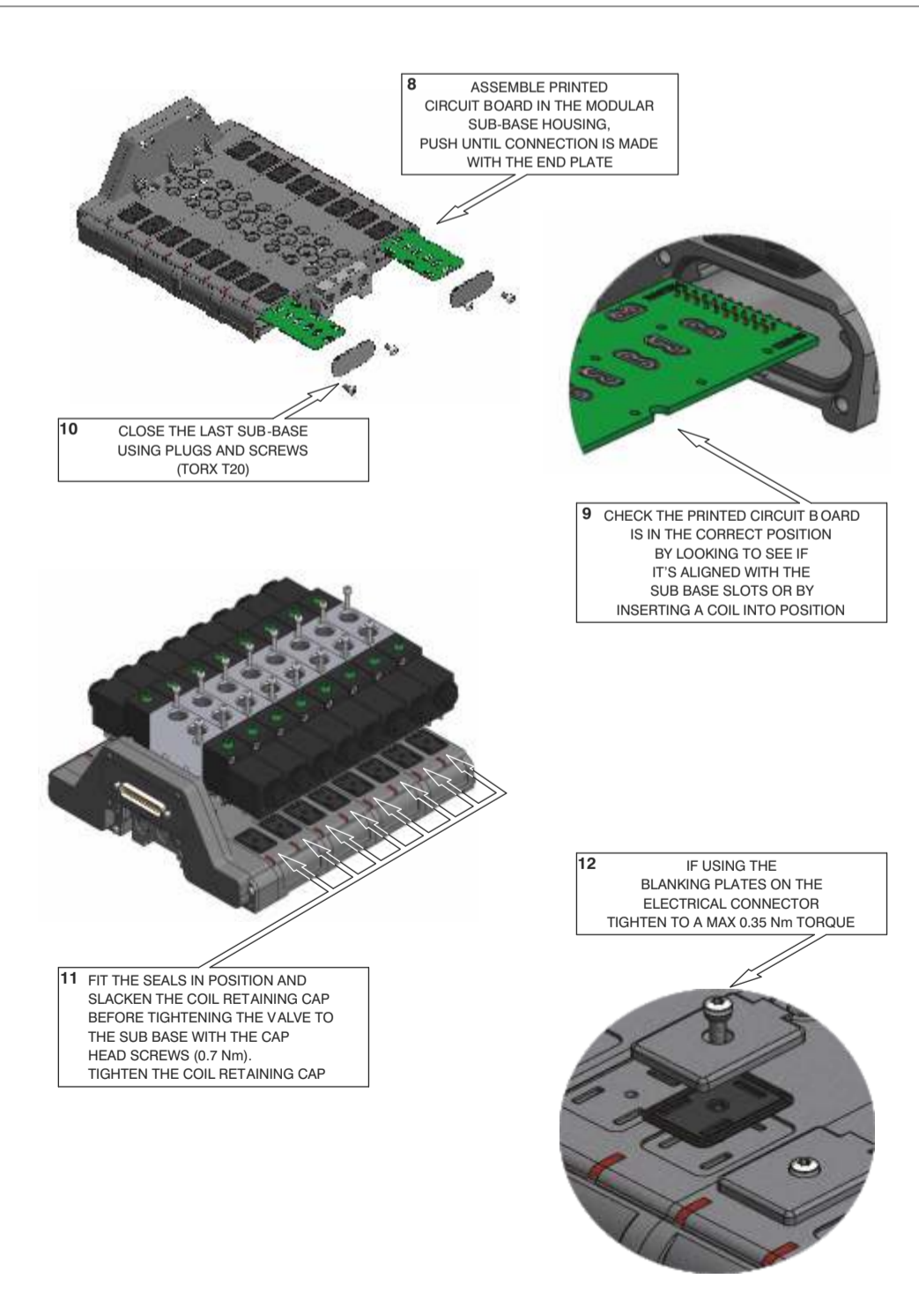
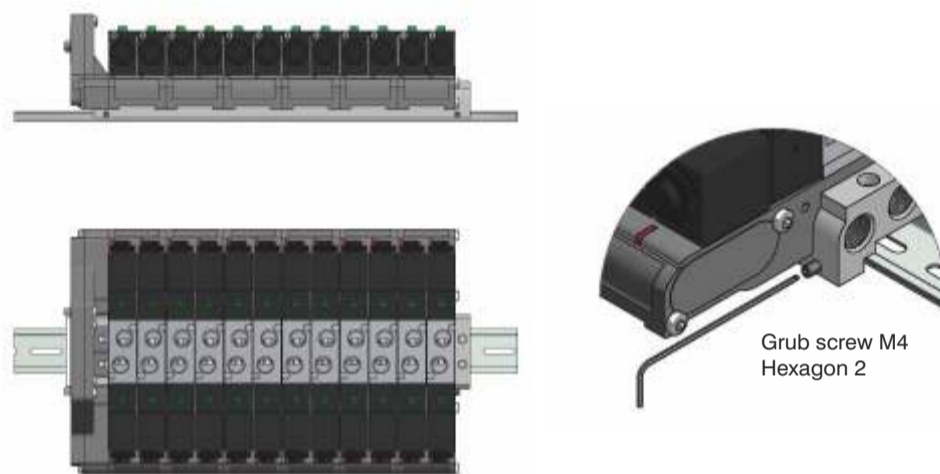

Electrical connection

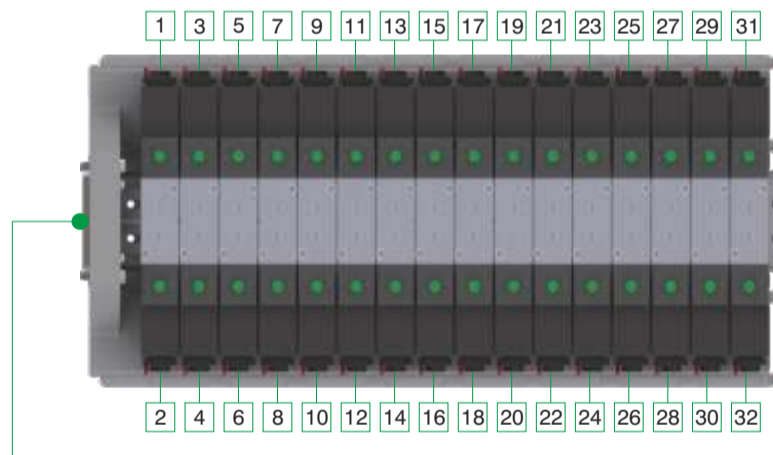

Connector 25 Poles from 1 to 11 Positions E.V. Bistable / Monostable

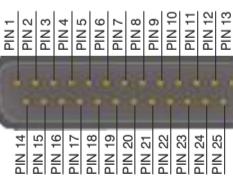

1 - 22 = SIGNALS
23 - 24 = GND
25 = NC

Connector 37 Poles from 1 to 16 Positions E.V. Bistable / Monostable

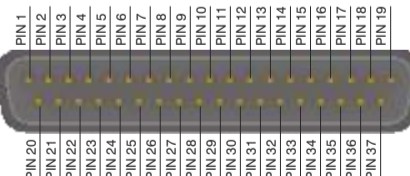

1 - 32 = SIGNALS
33 - 35 = GND
36 - 37 = NC

The electrical connection is achieved by a male SUB-D 37 pin connector which is able to manage up to 32 solenoid pilots.

As an option, a male SUB-D 25 pin connector is also available. This connector can manage up to 22 solenoid pilots.

Bistable 5/2 valve and 5/3 valves always require 2 electrical signals, since they are equipped with 2 electrical pilots.

Monostable 5/2 valves require a single electrical signal since they are equipped just with electrical pilot.

The maximum number of valves that can compose the manifold are with:

- 37P input connector = 16 bistable MAX
- 25P input connector = 11 bistable MAX