

DATI TECNICI DEI RACCORDI AUTOMATICI

Ø esterno tubo mm	Ø interno tubo mm	Pressioni di esercizio in bar dei raccordi con tubi per aria standard					
		-20°C +30°C		+31°C +50°C		+51°C +70°C	
		Rap	Tecno-Rap	Rap	Tecno-Rap	Rap	
4	2	18	12	18	12	18	
6	4	18	12	15	12	15	
8	6	15	12	15	12	11	
10	8	14	10	12	10	8	
12	10	14	10	12	10	8	
14	12	12	-	10	-	6	

TOLLERANZE AMMESSE NEI TUBI			
Ø esterno tubo	tolleranze sul Ø esterno		
da 4 a 5 mm	+0,05	-0,08	
da 6 a 14 mm	+0,05	-0,1	

TUBI IN POLIURETANO			
Ø esterno tubo	tolleranze sul Ø esterno		
da 4 a 14 mm	+0,15	-0,1	

DATI TECNICI

Temperature di utilizzo: Rap -20°C +70°C
Tecno-Rap -20°C +50°C

Fluido: Aria compressa (altri fluidi a richiesta)
Materiali: Corpo ottone nichelato / tecnopolimero
Guarnizioni NBR esente da silicone
Molla in acciaio AISI 304
Anello spingitore in Resina Acetalica
Filettatura: Cilindrica BSP con O-Ring UNI-ISO 228/1
Conica BSPT preteflonata UNI-ISO 7/1

CARATTERISTICHE PRINCIPALI

- 1 Passaggio pieno della portata
- 2 Aggancio automatico
- 3 Utilizzazione con i tubi Rilsan, Poliuretano, Nylon, Polietilene
- 4 Ingombri ridotti
- 5 Peso ridotto
- 6 Gamma modulare
- 7 Sede O-Ring sottotesta per tenuta su superfici piane
- 8 Atto a funzionare con il vuoto

TECHNICAL DATA FOR PUSH-IN FITTINGS

Outside pipe diameter mm	Inside pipe diameter mm	Working pressure in bar tested with standard air hoses					
		-20°C +30°C		+31°C +50°C		+51°C +70°C	
		Rap	Tecno-Rap	Rap	Tecno-Rap	Rap	
4	2	18	12	18	12	18	
6	4	18	12	15	12	15	
8	6	15	12	15	12	11	
10	8	14	10	12	10	8	
12	10	14	10	12	10	8	
14	12	12	-	10	-	6	

TOLERANCES FOR PA11 AND PA12 PIPES (Polyamide)			
Outside pipe diameter	Outside pipe diameter tolerance		
4 and 5 mm	+0,05	-0,08	
from 6 to 14 mm	+0,05	-0,1	

TOLERANCES FOR POLYURETHANE (PU) PIPES			
Outside pipe diameter	Outside pipe diameter tolerance		
from 4 to 14 mm	+0,15	-0,1	

TECHNICAL DATA

Working temperature: Rap -20°C +70°C
Tecno-Rap -20°C +50°C

Fluido: Compressed air (other fluids on request)
Material: Nickel-plated brass body / technopolymer body
Silicone-free NBR gaskets
AISI 304 stainless steel clamp
Synthetic material ring
Filettatura: Cylindrical BSP with O-Ring UNI-ISO 228/1
Tefloned BSPT taper thread UNI-ISO 7/1

MAIN FEATURES



- 1 Full flow
- 2 Can be inserted and extracted with one hand
- 3 Suitable for tubes Rilsan, Polyurethane, Nylon, Polyethylene
- 4 Supercompact
- 5 Extremely lightweight yet sturdy
- 6 Modular assembly for complex pipe systems
- 7 O-Ring provided with his own seat to ensure seal with polished surfaces
- 8 Suitable for vacuum application

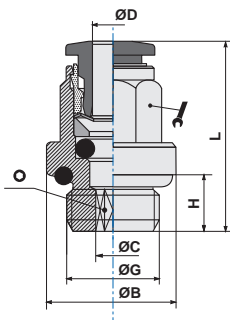



ART. 01

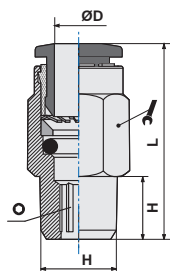

Diritto filetto cilindrico maschio con O-Ring
Straight male adaptor (parallel)

CODICE	ØD	G	ØC	ØB	H	L			
01CH04M5	4	M5	2,2	11,3	3,5	20	10	2	100
0104M5	4	M5	2,6	9	4	20,5	Ø9	2,5	100
0104M6	4	M6	2,6	9	5	20,5	Ø9	2,5	50
010418	4	1/8	2,6	13,5	5,5	20	9	2,5	50
010414	4	1/4	2,6	17	6,5	21	9	2,5	50
0105M5	5	M5	2,6	10	4	22	Ø10	2,5	50
010518	5	1/8	4,2	13,5	5,5	21,5	10	4	50
010514	5	1/4	4,2	17	6,5	20,5	10	4	50
0106M5	6	M5	2,6	11	4	22,8	Ø11	2,5	50
0106M6	6	M6	2,6	11	5	24,8	Ø11	2,5	50
010618	6	1/8	4,2	13,5	5,5	25,3	11	4	50
010614	6	1/4	4,2	17	6,5	24,3	11	4	50
010818	8	1/8	5,2	12,8	5,5	27	13	5	50
010814	8	1/4	6,2	17	6,5	25,5	13	6	50
010838	8	3/8	6,2	20	7,5	25,5	13	6	50
010812	8	1/2	13,0	24	10	24	14	6	25
011018	10	1/8	5,9	9	5,5	29	17	4	25
011014	10	1/4	7,3	16	6,5	30,4	16	7	50
011038	10	3/8	8,3	21	7,5	30,9	16	8	50
011012	10	1/2	14,1	23	10	24,7	24	8	25
011214	12	1/4	7,3	16	6,5	33,2	19	7	25
011238	12	3/8	10,3	22	7,5	33,2	19	10	25
011212	12	1/2	10,3	24	9	33,2	19	10	25
011438	14	3/8	10,3	21	7,5	35	21	10	25
011412	14	1/2	12,3	25	9	35	21	12	25



ART. 01C

Diritto filetto conico maschio
Straight male adaptor (tapered)

CODICE	ØD	G		H	L			
01C0418	4	1/8		7,5	18	10	2,5	50
01C0414	4	1/4		9,5	16	14	2,5	50
01C0438	4	3/8		7,5	17,4	17	3	25
01C0618	6	1/8		7,5	19,5	12	4	50
01C0614	6	1/4		9,5	22,3	14	4	50
01C0638	6	3/8		10,5	20,3	17	4	25
01C0612	6	1/2		10	23,2	24	4	25
01C0818	8	1/8		7,5	25,5	14	5	50
01C0814	8	1/4		9,5	24,5	14	6	50
01C0838	8	3/8		10,5	21,5	17	6	50
01C0812	8	1/2		12,5	25,5	21	6	25
01C1018	10	1/8		7,5	29,5	17	4	25
01C1014	10	1/4		9,5	30,8	17	7	50
01C1038	10	3/8		10,5	28,3	17	8	50
01C1012	10	1/2		13,5	26,6	21	8	25
01C1218	12	1/8		7	31	21	4	25
01C1214	12	1/4		9,5	33	21	7	25
01C1238	12	3/8		10,5	30	21	10	25
01C1212	12	1/2		13,5	32,5	21	10	25
01C1438	14	3/8		9	37,5	21	10	25
01C1412	14	1/2		11	35	22	10	25

ART. 02 Diritto femmina
Straight female adaptor

CODICE	ØD	G	ØC	ØB	H	L		
0204M5	4	M5	5	9	4,5	23	9	50
020418	4	1/8	3	12	6,5	26,5	9	50
020414	4	1/4	3	17	10	29,5	9	50
020618	6	1/8	5	12	6,5	28,3	11	50
020614	6	1/4	5	17	10	31,3	11	50
020818	8	1/8	7	12	6,5	28,5	13	50
020814	8	1/4	7	17	10	32,5	13	50

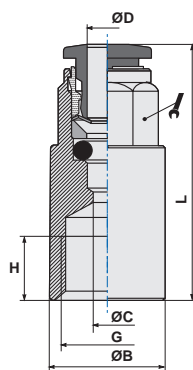

ART. 03 Diritto innestabile
Straight connector

CODICE	ØD	ØD1	ØB	ØC	L		
030400	4	4	3	11	32		50
030500	5	5	4	12	33		50
030406	4	6	3	13	34,8		50
030600	6	6	5	13	36,1		50
030608	6	8	5	15	37,8		50
030800	8	8	7	15	38		50
030810	8	10	7	18	40,9		50
031000	10	10	9	18	42,3		50
031200	12	12	11	21	45,8		25
031400	14	14	13	23	48,9		25

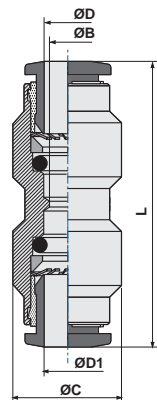

ART. 03F Diritto innestabile filettato
Threaded connector

CODICE	ØD	ØC	M	L		
03F0400	4	3	11x1	32		50
03F0500	5	4	11x1	33		50
03F0600	6	5	14x1	36,1		50
03F0800	8	7	16x1	38		50
03F1000	10	9	18x1	42,3		50
03F1200	12	11	22x1	45,8		25
03F1400	14	13	24x1	47,5		25

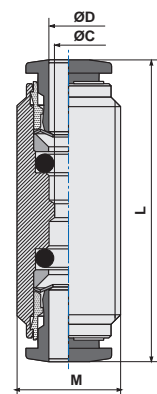

ART. 04 Gomito innestabile
Elbow connector

CODICE	ØD	ØC	ØB	L		
040400	4	3	10	19		50
040600	6	5	11	20,6		50
040800	8	7	13	23		50
041000	10	8	16	26,4		50
041200	12	10	19	28,9		25
041400	14	12	21	31,5		25

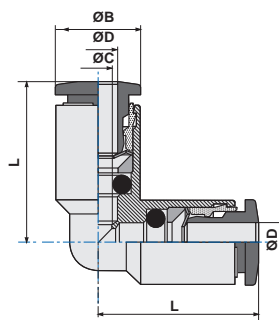

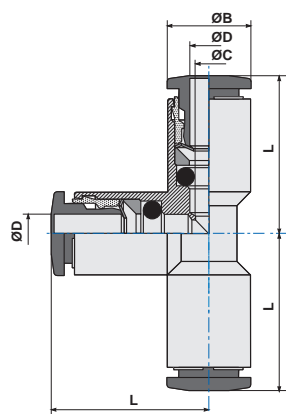

ART. 05 T innestabile
T connector

CODICE	ØD		ØC	ØB		L			
050400	4		3	9		17,3			50
050600	6		5	11		20,6			50
050800	8		7	13		23			50
051000	10		8	16		26,4			25
051200	12		10	19		28,9			25
051400	14		12	21		31,5			25

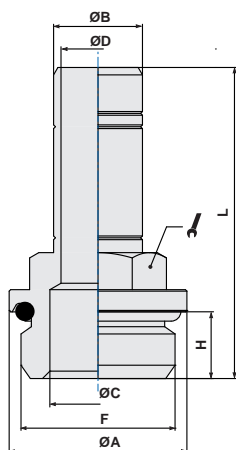

ART. 06 Innesto filetto cilindrico con O-Ring
Adaptor parallel (short)

CODICE	ØB	F	ØA	ØC	ØD	H	L		
0604M5	4	M5	8	2	2	4	24,7	8	50
060418	4	1/8	13	5,5	2	5,5	27,7	13	50
060414	4	1/4	16	7,5	2	6,5	29,2	13	50
0604M6	4	M6	9	2	2	5	25,7	8	50
0604M7	4	M7	11	3,5	2	5,5	26,2	9	50
0606M5	6	M5	8	2,6	2,6	4	27,5	8	50
0606M6	6	M6	9	2,6	2,6	5	29,0	8	50
0606M7	6	M7	11	3,5	3,5	5,5	29,0	9	50
060618	6	1/8	13	5,5	4	5,5	30,5	13	50
060614	6	1/4	16	7,5	4	6,5	32,0	13	50
060818	8	1/8	13	6	6	5,5	32,0	13	50
060814	8	1/4	16	7,5	6	6,5	33,5	13	50
060838	8	3/8	20	9	6	7,5	35,5	13	50
061018	10	1/8	13	6	6	5,5	35,0	13	50
061014	10	1/4	16	8	8	6,5	36,5	13	50
061038	10	3/8	20	8	8	7,5	39,5	13	50
061012	10	1/2	24	13	8	9	41,0	16	50
061214	12	1/4	16	8	8	6,5	37,5	13	25
061238	12	3/8	20	11	10	7,5	40,5	13	25
061212	12	1/2	24	13	10	9	42,0	16	25
061438	14	3/8	20	12	12	7,5	43,0	16	25
061412	14	1/2	24	13	12	9	44,5	16	25

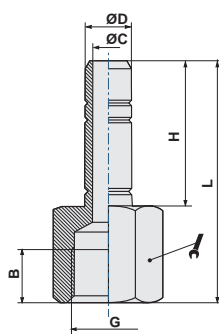

ART. 06F Innesto filetto cilindrico femmina
Female parallel adaptor

CODICE	ØD	G	ØC	B	H	L		
06F0418	4	1/8	2	7	16,7	29,7	12	50
06F0618	6	1/8	4	7	19,5	32,5	12	50
06F0614	6	1/4	4	8	19,5	35,5	17	50
06F0814	8	1/4	6	8	21	37	17	50

ART. 60 Innesto prolungato filetto cilindrico con O-Ring
Adaptor parallel long

CODICE	ØD	G	ØC	ØB	H	L	ØA		
600418	4	1/8	2	13	5,5	39,2	6	13	50
600618	6	1/8	4	13	5,5	45	6	13	50
600614	6	1/4	4	16	6,5	47,5	7,5	13	50
600818	8	1/8	6	13	5,5	48,5	6	13	50
600814	8	1/4	6	16	6,5	51	7,5	13	50
600838	8	3/8	6	20	7,5	51,5	9	13	50
601014	10	1/4	8	16	6,5	54	7,5	13	50
601038	10	3/8	8	13	7,5	57,5	9	13	25

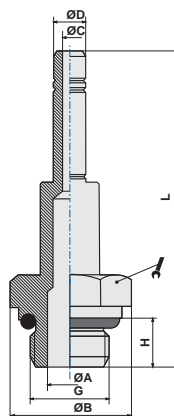

ART. 07 Prolungamento
Connector

CODICE	ØD	ØC	L	
070400	4	2	33,4	100
070600	6	4	39	50
070800	8	6	49	50
071000	10	8	48	50
071200	12	10	50	25
071400	14	12	55	25

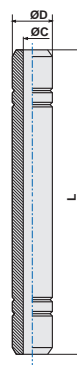

ART. 08 Riduzione con codolo
Plug-in reducer

CODICE	ØD1	ØD2	ØB	L	
080604	6	4	9	32,5	50
080804	8	4	9	34	50
080806	8	6	11	36	50
081006	10	6	11	39,3	50
081008	10	8	13	39	50
081204	12	4	13	40	25
081206	12	6	13	40,3	25
081208	12	8	13	39,5	25
081210	12	10	16	41,4	25
081404	14	4	15	43,5	25
081406	14	6	15	43,8	25
081408	14	8	15	44	25
081410	14	10	16	43,9	25
081412	14	12	19	45,9	25

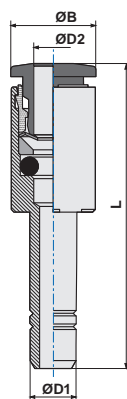

ART. 08/E Maggiorazione con codolo
Plug-in increaser

CODICE	ØD1	ØD2	ØB	L	
08E0406	4	6	11	35,5	50
08E0608	6	8	13	39	50

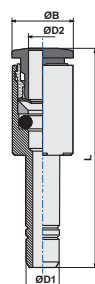

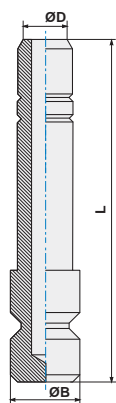

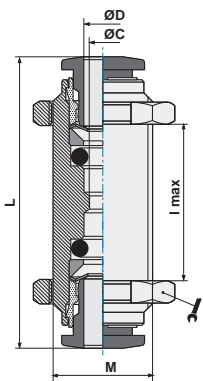

ART. 09 Tappo
Plug

CODICE	ØD	ØB		L	
090400	4	5		26	50
090600	6	7		29	50
090800	8	9		31,5	50
091000	10	11		35	50
091200	12	13		37	25
091400	14	15		39,5	25



ART. 10 Passaparete
Bulkhead connector

CODICE	ØD	ØC	M	l max	L		
100400	4	3	11x1	8	32	14	50
100600	6	5	14x1	8	36,1	17	50
100800	8	7	16x1	10	38	18	50
101000	10	9	18x1	12	42,3	21	25
101200	12	11	22x1	17	45,8	26	25
101400	14	13	24x1	18	47,5	27	25

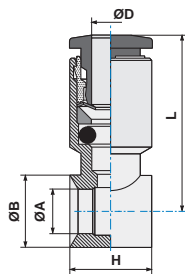

ART. 13 Anello semplice
Single banjo body

CODICE	ØD	G*	ØA	ØB	H	L	
1304M5	4	M5	5	8	9	19,5	50
130418	4	1/8	9,9	14	15	21,1	50
1305M5	5	M5	5	9	9	19,5	50
130518	5	1/8	9,3	14	15	22,5	50
130618	6	1/8	9,9	14	15	24,3	50
130614	6	1/4	13,3	18	17	25,5	50
130638	6	3/8	16,75	21	20	28	25
130818	8	1/8	9,9	14	15	24,8	50
130814	8	1/4	13,3	18	17	26,5	50
130838	8	3/8	16,75	21	20	28,0	50
131014	10	1/4	13,3	18	17	28,4	50
131038	10	3/8	16,75	21	20	29,9	25
131214	12	1/4	13,3	18	17	30,9	25
131238	12	3/8	16,75	21	20	31,4	25
131212	12	1/2	21	26	24	34,9	25
131412	14	1/2	21	26	24	35,5	25

(*) G = filetto vite/asta
(*) G = steam thread

ART. 14 Anello doppio
Double banjo body

CODICE	ØD	G*	ØA	ØB	H	L			
1404M5	4	M5	5	8	9	19,5			50
140418	4	1/8	9,9	14	15	21,1			50
140618	6	1/8	9,9	14	15	24,3			50
140614	6	1/4	13,3	18	17	25,5			50
140818	8	1/8	9,9	14	15	24,8			50
140814	8	1/4	13,3	18	17	26,5			50
140838	8	3/8	16,75	21	20	28			50
141014	10	1/4	13,3	18	17	28,4			50
141038	10	3/8	16,75	21	20	29,9			25

(*) G = filetto vite/asta
(*) G = steam thread

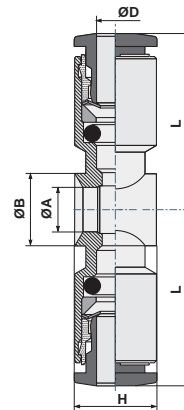

ART. 15 Anello semplice girevole con asta
Complete single banjo (rotating under pressure)

CODICE	ØD	G	ØA	H	L1	L			
1504M5	4	M5	2	4	16,8	19,5	2,5		50
1504M6	4	M6	2	4	17,8	19,5	2,5		50
150418	4	1/8	5,5	5,5	25	21,1	3		50
1505M5	5	M5	2	4	17,8	19,5	2,5		50
150518	5	1/8	5,5	5,5	24,5	22,5	3		50
1506M5	6	M5	2	4	16,5	22	2,5		50
150618	6	1/8	5,5	5,5	24,5	24,3	3		50
150614	6	1/4	7,8	6,5	28	25,5	4		50
150638	6	3/8	7,8	7,5	34	28	5		25
150818	8	1/8	5,5	5,5	24,5	24,8	3		50
150814	8	1/4	7,8	6,5	28	26,5	4		50
150838	8	3/8	10	7,5	34	28	5		25
151014	10	1/4	7,8	6,5	28	28,4	4		25
151038	10	3/8	10	7,5	34	29,9	5		25
151214	12	1/4	7,8	6,5	28	30,9	4		25
151238	12	3/8	10	7,5	34	31,4	5		25
151212	12	1/2	12	9	40,8	34,9	8		10
151412	14	1/2	12	9	40,8	35,5	8		10

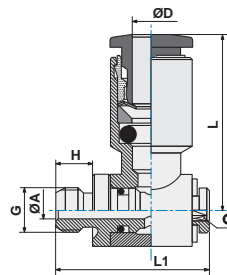

ART. 16 Anello doppio girevole con asta
Complete double banjo (rotating under pressure)

CODICE	ØD	G	ØA	H	L1	L			
1604M5	4	M5	2	4	16,8	19,5	2,5		50
160418	4	1/8	5,5	5,5	24,5	21,1	3		50
160618	6	1/8	5,5	5,5	24,5	24,3	3		50
160614	6	1/4	7,8	6,5	28	25,5	4		50
160818	8	1/8	5,5	5,5	25	24,8	3		50
160814	8	1/4	7,8	6,5	28	26,5	4		25
160838	8	3/8	10	7,5	34	28	5		25
161014	10	1/4	7,8	6,5	28	28,4	4		25
161038	10	3/8	10	7,5	34	29,9	5		25

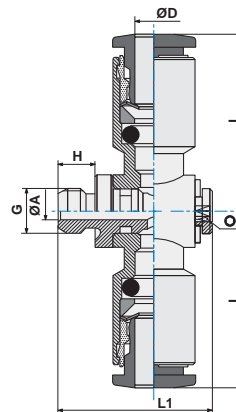

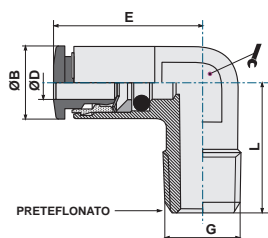

ART. 19 Raccordo ad elle fisso
Elbow male adaptor

CODICE	ØD	G	ØB	E	L		
190418	4	1/8	9	18,6	16,5	10	100
190618	6	1/8	11	23,8	16,5	10	100
190614	6	1/4	11	25,3	22,5	11	100
190818	8	1/8	13	25,5	18,5	11	100
190814	8	1/4	13	25,5	22,0	11	100
191014	10	1/4	16	28,0	24,0	13	50

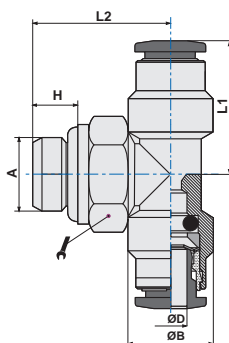

ART. 20 Raccordo a T centrale girevole
Swivel male stud tee parallel

CODICE	ØD	A	H	ØB	L1	L2		
2004M5	4	M5	4	9	17,3	20,0	8	50
200418	4	1/8	5,5	11,40	17,3	18,5	13	50
200414	4	1/4	6,5	9	19,0	22,5	16	50
2006M5	6	M5	4	11,20	20,5	21	8	50
200618	6	1/8	5,5	11	19,5	18,5	13	50
200614	6	1/4	6,5	11	22,1	22,5	16	50
200818	8	1/8	5,5	13	23,0	20,5	13	50
200814	8	1/4	6,5	13	23,0	22,5	16	50
200838	8	3/8	7,5	13	24,5	25,5	18	25
201014	10	1/4	6,5	16	26,4	24,5	16	25
201038	10	3/8	7,5	16	26,4	25,5	18	25

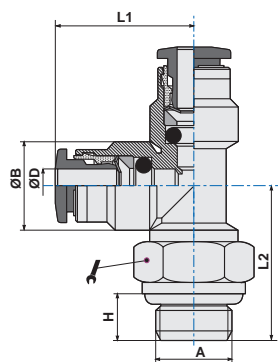

ART. 21 Raccordo a T laterale girevole
Swivel male branch tee parallel

CODICE	ØD	A	H	ØB	L1	L2		
2104M5	4	M5	4	9	17,3	20,0	8	50
210418	4	1/8	5,5	9	17,3	18,5	13	50
210414	4	1/4	6,5	9	19,0	22,5	16	50
210618	6	1/8	5,5	11	20,6	18,5	13	50
210614	6	1/4	6,5	11	22,1	22,5	16	50
210818	8	1/8	5,5	13	23,0	20,5	13	50
210814	8	1/4	6,5	13	23,0	22,5	16	50
210838	8	3/8	7,5	13	24,5	25,5	18	50
211014	10	1/4	6,5	16	26,4	24,5	16	25
211038	10	3/8	7,5	16	26,4	25,5	18	25

ART. 22 Gomito girevole filetto cilindrico maschio con O-Ring
Swivel elbow male adaptor parallel

CODICE	ØD	A	H	ØB	L1	L2		
2204M5	4	M5	4	9	17,3	20,0	8	100
220418	4	1/8	5,5	11	17,3	18,5	13	100
220414	4	1/4	6,5	9	19,0	22,5	16	100
2206M5	6	M5	4	11	20,0	20,6	8	100
220618	6	1/8	5,5	11	20,6	18,5	13	100
220614	6	1/4	6,5	11	22,1	22,5	16	100
220818	8	1/8	5,5	13	23,0	20,5	13	100
220818+	8	1/8	5,5	12	22,0	18,0	13	100
220814	8	1/4	6,5	13	23,0	22,5	16	100
220838	8	3/8	7,5	13	24,5	25,5	18	50
221014	10	1/4	6,5	16	26,4	24,5	16	50
221038	10	3/8	7,5	16	26,4	25,5	18	50
221012	10	1/2	9	17	27,9	29,0	21	50
221214	12	1/4	6,5	19	28,9	24,5	16	50
221238	12	3/8	7,5	19	28,9	24,5	18	25
221212	12	1/2	9	19	28,9	31,0	21	25
221438	14	3/8	7,5	21	31,5	28,0	18	25
221412	14	1/2	9	21	31,5	33,0	21	25

+(plus) = passaggio aria maggiorato
+(plus) = increased air flow

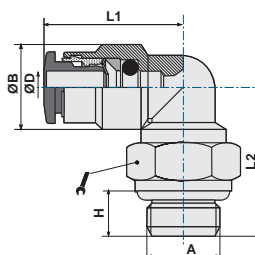

ART. 25 Passaparete femmina
Female bulkhead

CODICE	ØA	C	ØB	D	E	L		
250418	4	1/8	M12x1	15,5	8,5	24,0	14	25
250618	6	1/8	M14x1	15,8	8,5	26,8	15	25
250614	6	1/4	M14x1	15,8	11,0	29,5	17	25
250818	8	1/8	M16x1	16,0	8,5	26,5	19	25
250814	8	1/4	M16x1	16,0	11,0	32,0	19	25

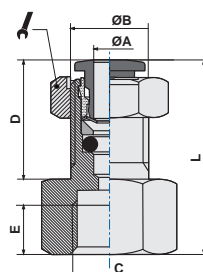

ART. 27 Cartuccia
Cartridge

CODICE	ØD	ØC	ØB	H	
270400	4	2,9	7,8	14	100
270600	6	4,5	10,0	16	50
270800	8	6,5	12,0	17	50

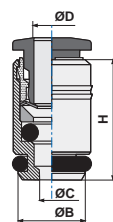

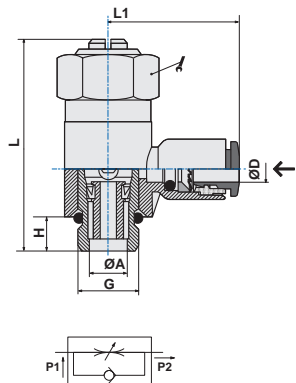

ART. 28

Regolatore di flusso unidirezionale per valvola

Unidirectional flow regulator for valve

CODICE	ØD	G	ØA	H	L1	L		
2804M5	4	M5	1,9	4,0	19,5	21,5	10	25
280418	4	1/8	5,5	5,5	21,1	34,0	14	25
280618	6	1/8	5,5	5,5	24,3	34,0	14	25
280614	6	1/4	6,0	6,5	25,5	42,0	17	25
280818	8	1/8	5,5	5,5	24,8	34,0	14	25
280814	8	1/4	6,0	6,5	26,5	42,0	17	25
280838	8	3/8	8,0	7,5	28,0	52,0	20	10
281014	10	1/4	6,0	6,5	28,4	42,0	17	25
281038	10	3/8	8,0	7,5	29,9	52,0	20	10
281238	12	3/8	8,0	7,5	31,4	52,0	20	10

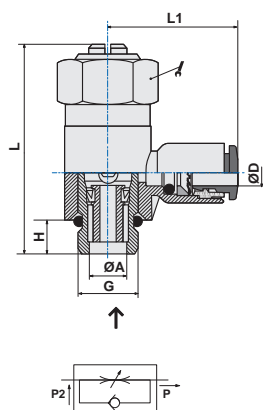

ART. 29

Regolatore di flusso unidirezionale per cilindro

Unidirectional flow regulator for cylinder

CODICE	ØD	G	ØA	H	L1	L		
2904M5	4	M5	1,9	4,0	19,5	21,5	10	25
290418	4	1/8	5,0	5,5	21,1	34,0	14	25
2906M5	6	M5	1,9	4,0	22,5	21,5	10	25
290618	6	1/8	5,0	5,5	24,3	34,0	14	25
290614	6	1/4	6,0	6,5	25,5	42,0	17	25
290818	8	1/8	5,0	5,5	24,8	34,0	14	25
290814	8	1/4	6,0	6,5	26,5	42,0	17	25
290838	8	3/8	6,5	7,5	28,0	52,0	20	10
291014	10	1/4	6,0	6,5	28,4	42,0	17	25
291038	10	3/8	6,5	7,5	29,9	52,0	20	10
291238	12	3/8	6,5	7,5	31,4	52,0	20	10
291212	12	1/2	10,0	9	34,9	61,0	26	10
291412	14	1/2	10,0	9	35,5	61,0	26	10

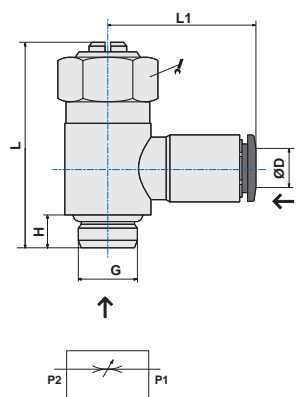

ART. 30



Regolatore di flusso bidirezionale

Bidirectional flow regulator

CODICE	ØD	G	H	L1	L		
300418	4	1/8	5,5	21,1	34	14	25
300618	6	1/8	5,5	24,3	34	14	25
300614	6	1/4	6,5	25,5	42	17	25
300818	8	1/8	5,5	24,8	34	14	25
300814	8	1/4	6,5	26,5	42	17	25
300838	8	3/8	7,5	28,0	52	20	10
301014	10	1/4	6,5	28,4	42	17	25
301038	10	3/8	7,5	29,9	52	20	10
301238	12	3/8	7,5	31,4	52	20	10
*301212	12	1/2	9	34,9	61	26	10
*301412	14	1/2	9	35,5	61	26	10



* con rondelle in plastica
* with plastic washer

ART. 28P Regolatore di flusso per valvola girevole Swivel flow regulator for valve

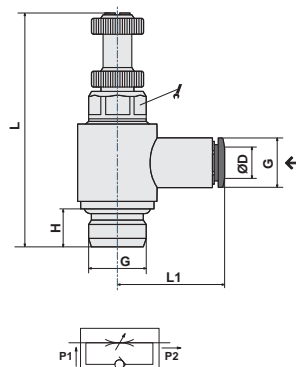
CODICE	ØD	G	H	L	L1		
2804M5P	4	5	4	19,5	33,7	8	25
280418P	4	1/8	5,5	43,0	21,1	9	25
280618P	6	1/8	5,5	43,0	24,3	9	25
280818P	8	1/8	5,5	43,0	24,8	9	25
280614P	6	1/4	6,5	50,0	25,5	12	25
280814P	8	1/4	6,5	50,0	26,5	12	25
281014P	10	1/4	6,5	50,0	28,4	12	25



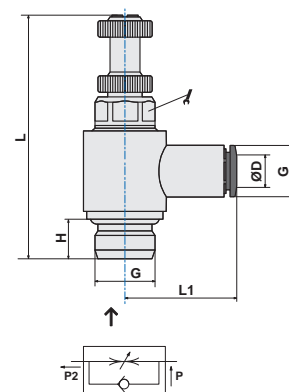

ART. 29P Regolatore di flusso per cilindro girevole Swivel flow regulator for cylinder

CODICE	ØD	G	H	L	L1		
2904M5P	4	M5	4	19,5	33,7	8	25
290418P	4	1/8	5,5	43,0	21,1	9	25
2906M5P	4	M5	4	22,0	33,7	8	25
290618P	6	1/8	5,5	43,0	24,3	9	25
290818P	8	1/8	5,5	43,0	24,8	9	25
290614P	6	1/4	6,5	50,0	25,5	12	25
290814P	8	1/4	6,5	50,0	26,5	12	25
291014P	10	1/4	6,5	50,0	28,4	12	25



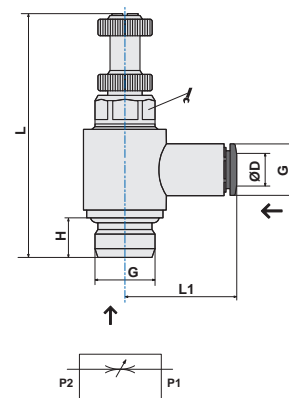

ART. 30P Regolatore di flusso bidirezionale Bidirectional flow regulator

CODICE	ØD	G	H	L	L1		
300418P	4	1/8	5,5	43	21,1	9	25
300618P	6	1/8	5,5	43	24,3	9	25
300818P	8	1/8	5,5	43	24,8	9	25
300614P	6	1/4	6,5	50	25,5	12	25
300814P	8	1/4	6,5	50	26,5	12	25
301014P	10	1/4	6,5	50	28,4	12	25

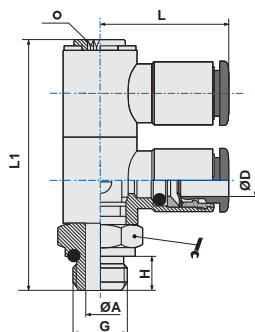



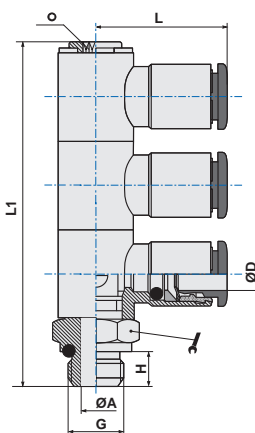

ART. 33 Doppio anello semplice girevole con asta
Swivel double banjo stem

CODICE	ØD	G	ØA	H	L1	L			
330418	4	1/8	5,5	5,5	43,8	21,1	14	3	25
330618	6	1/8	5,5	5,5	43,8	24,3	14	3	25
330818	8	1/8	5,5	5,5	43,8	24,8	14	3	25
330614	6	1/4	7,8	7,5	51,5	25,5	18	4	25
330814	8	1/4	7,8	7,5	51,5	26,5	18	4	25
331014	10	1/4	7,8	7,5	51,5	28,4	18	4	25



ART. 34 Triplo anello semplice girevole con asta
Swivel triple banjo stem

CODICE	ØD	G	ØA	H	L1	L			
340418	4	1/8	5,5	5,5	58,4	21,1	14	3	10
340618	6	1/8	5,5	5,5	58,4	24,3	14	3	10
340818	8	1/8	5,5	5,5	58,4	24,8	14	3	10
340614	6	1/4	7,8	7,5	67	25,5	18	4	10
340814	8	1/4	7,8	7,5	67	26,5	18	4	10
341014	10	1/4	7,8	7,5	67	51,5	18	4	10



- Serie OT, versione con o-ring in NBR
- Serie OV, versione con o-ring in VITON
- Articoli disponibili su richiesta
- Dimensioni e codici come da tabelle serie Rap

- OT series with NBR seals
- OV series, with VITON seals
- Items available on demand only
- Sizes and codes according to Rap series tables