



#### ART. T01

Diritto filetto cilindrico maschio con O-Ring  
Straight male adaptor (parallel)

CODICE	ØD	G	ØC	ØB	H	L			
T0104M10	4	M10	2,5	14,0	7,5	21,3	10	2,5	50
T010418	4	1/8	2,5	14,0	5,5	19,0	10	2,5	50
T010414	4	1/4	2,5	17,5	6,5	20,8	10	4,0	50
T0106M10	6	M10	4,0	14,0	7,5	26,8	12	4,0	50
T010618	6	1/8	4,0	14,0	5,5	24,5	12	4,0	50
T010614	6	1/4	4,0	17,5	6,5	26,0	12	4,0	50
T0108M10	8	M10	6,0	14,0	7,5	28,1	14	5,0	50
T010818	8	1/8	5,0	14,0	5,5	25,7	14	5,0	50
T010814	8	1/4	6,0	17,5	6,5	27,2	14	6,0	50
T011014	10	1/4	7,0	17,5	6,5	28,7	18	7,0	50

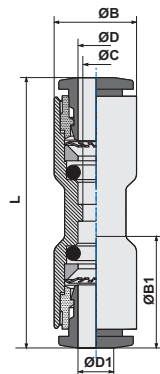

#### ART. T03

Diritto innestabile  
Straight connector

CODICE	ØD	ØD1	ØC	ØB	ØB1	L	
T030400	4	4	3	9,5	9,5	32,0	50
T030406	4	6	3	9,5	11,5	32,5	50
T030600	6	6	5	11,5	11,5	35,6	50
T030608	6	8	5	11,5	13,5	36,0	50
T030800	8	8	7	13,5	13,5	38,0	25
T030810	8	10	7	13,5	17,0	32,5	50
T031000	10	10	9	17,0	17,0	42,3	50
T031012	10	12	9	17,0	20,0	44,0	50
T031200	12	12	10	20,0	20,0	46,2	25

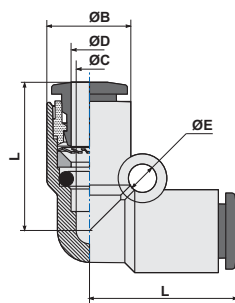

#### ART. T04

Gomito innestabile  
Elbow connector

CODICE	ØD	ØC	ØB	L	ØE	
T040400	4	3	9,5	17,2	3,2	50
T040600	6	5	11,5	20,8	3,2	50
T040800	8	7	13,5	23,0	3,2	50
T041000	10	9	17,0	26,4	4,3	50
T041200	12	10	20,0	28,9	4,2	25

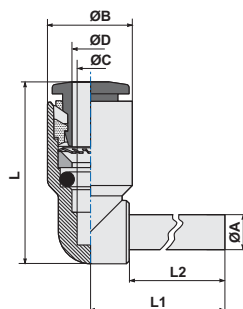

#### ART. T04LO

Gomito innestabile con codolo  
Plug-in elbow connector

CODICE	ØD	ØC	ØB	L	L1	ØA	L2	
T0404L0	4	3	9,5	17,2	20,75	4	16,7	50
T0406L0	6	5	11,5	20,8	24,25	6	19,5	50
T0408L0	8	7	13,5	23,0	27,25	8	21,0	50
T0410L0	10	9	17,0	26,4	31,80	10	24,0	50
T0412L0	12	10	20,0	28,9	36,00	12	25,0	25

ART. T05 T innestabile  
T connector

CODICE	ØD	ØD1	ØC	ØB	L		
T050400	4	4	3,0	9,5	17,2		50
T050604	6	4	5,3	13,0	19,2		50
T050600	6	6	5,0	11,5	20,8		50
T050806	8	6	7,1	14,4	22,7		50
T050800	8	8	7,0	13,5	23,0		50
T051008	10	8	9,3	18,4	27,9		25
T051000	10	10	9,0	17,0	26,4		25
T051210	12	10	10,0	21,0	29,9		25
T051200	12	12	10,0	20,0	28,9		10

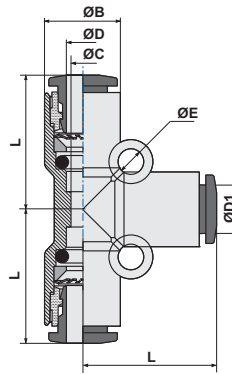

ART. T05LO T Innestabile con codolo centrale  
Plug-in tee connector (center)

CODICE	ØD	ØC	ØB	L	L1	ØA	L2	
T0504L0	4	3	9,5	17,2	20,75	4	16,7	50
T0506L0	6	5	11,5	20,8	24,25	6	19,5	50
T0508L0	8	7	13,5	23,0	27,25	8	21,0	50
T0510L0	10	9	17,0	26,4	31,80	10	24,0	25
T0512L0	12	10	20,0	28,9	36,00	12	25,0	10

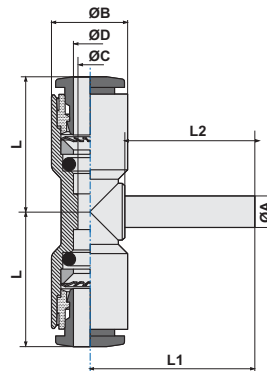

ART. T05VO T Innestabile con codolo laterale  
Plug-in tee connector (lateral)

CODICE	ØD	ØB	L	L1	ØA	L2	
T0504V0	4	9,5	17,2	20,75	4	16,7	50
T0506V0	6	11,5	20,8	24,25	6	19,5	50
T0508V0	8	13,5	23,0	27,25	8	21,0	50
T0510V0	10	17,0	26,4	31,80	10	24,0	25
T0512V0	12	20,0	28,9	36,00	12	25,0	10

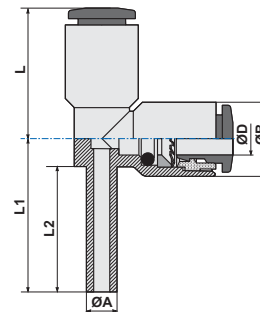

ART. T06 Innesto filetto cilindrico con O-Ring  
Adaptor parallel (short)

CODICE	ØD	G	ØC	ØB	H	L	ØA		
T060418	4	1/8	2	14	5,5	28,7	6,0	14	50
T060414	4	1/4	2	18	6,5	30,7	8,0	16	50
T060618	6	1/8	4	14	5,5	31,5	6,0	14	50
T060614	6	1/4	4	18	6,5	33,5	7,8	16	50
T060818	8	1/8	6	14	5,5	33,0	6,0	14	50
T060814	8	1/4	6	18	6,5	35,0	8,0	16	50
T061014	10	1/4	8	18	6,5	38,0	8,0	16	50
T061214	12	1/4	9	18	6,5	39,0	8,0	16	25

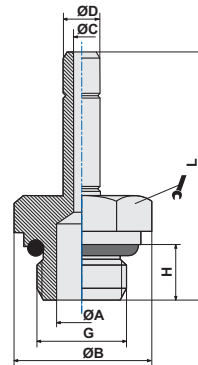

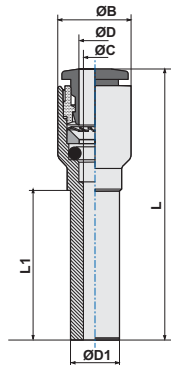

ART. T08 Riduzione  
Reducer

CODICE	ØD1	ØD	ØC	ØB	L	L1	
T080604	6	4	3	9,5	35,5	19,5	50
T080804	8	4	3	9,5	37,0	21,0	50
T081004	10	4	3	9,5	40,0	24,0	25
T081204	12	4	3	9,5	41,0	25,0	25
T080806	8	6	5	11,5	39,05	23,0	50
T081006	10	6	5	11,5	42,05	24,0	25
T081206	12	6	5	11,5	43,05	25,0	25
T081008	10	8	7	13,5	43,0	26,25	25
T081208	12	8	7	13,5	44,0	25,0	25
T081210	12	10	9	17,0	46,15	27,55	25

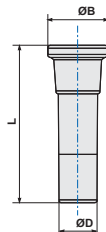

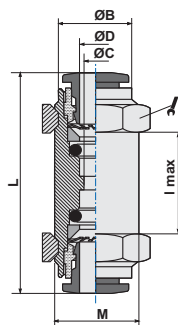

ART. T09 Tappo  
Plug

CODICE	ØD	ØB	L	
T090400	4	7,0	25,0	100
T090600	6	9,5	27,5	100
T090800	8	12,0	30,0	100
T091000	10	14,0	32,5	100
T091200	12	16,0	35,0	100



ART. T10 Passaparete  
Bulkhead connector

CODICE	ØD	ØB	L	M	I max		
T100400	4	9,5	32,0	11x1	8	14	50
T100600	6	11,5	36,1	14x1	8	17	50
T100800	8	13,5	38,0	16x1	10	18	50
T101000	10	17,5	42,3	20x1	12	24	25
T101200	12	20,0	46,2	22x1	17	26	25

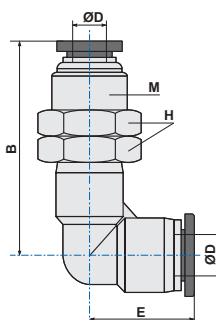

ART. T10L Passaparete a "L"  
Elbow bulkhead

CODICE	ØD	M	B	E	H	
T10L0400	4	12x1	28,5	19,0	14	25
T10L0600	6	14x1	32,1	19,2	17	25
T10L0800	8	16x1	39,4	23,0	19	25
T10L1000	10	20x1	44,8	28,2	24	25
T10L1200	12	22x1	46,6	29,5	27	50

ART. T11 Croce intermedio  
Cross connector

CODICE	ØD		ØB	ØA	C	
T110400	4		9,5	17,2	3	25
T110600	6		11,5	20,8	3	25
T110800	8		13,5	23,0	3	25
T111000	10		17,0	6,5	3	25
T111200	12		20,0	28,8	3	10

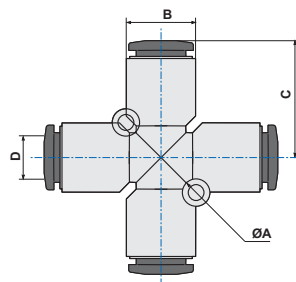

ART. T13 Anello semplice  
Single banjo body

CODICE	ØD	G*	ØC	ØB	H	L	ØF	
T1304M5	4	M5	3	9,5	10	19,5	8,0	50
T130418	4	1/8	3	9,5	15	21,1	14,0	50
T130618	6	1/8	5	11,5	15	24,3	14,0	50
T130614	6	1/4	5	11,5	17	25,5	18,0	50
T130818	8	1/8	7	13,5	15	24,8	14,0	50
T130814	8	1/4	7	13,5	17	26,5	18,0	50
T130838	8	3/8	7	13,5	20	28,0	21,3	50
T131014	10	1/4	9	17,0	17	28,4	18,0	50
T131038	10	3/8	9	17,0	20	29,9	21,3	25
T131012	10	1/2	9	17,0	24	30,0	26,0	25
T131238	12	3/8	10	20,0	20	31,4	21,3	25
T131212	12	1/2	10	20,0	24	34,9	26,0	25

(\*) G = filetto vite/asta  
(\*) G = steam thread

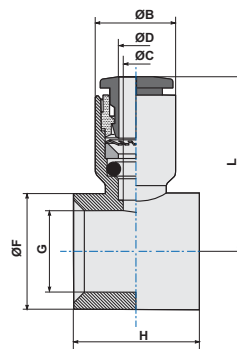

ART. T13B Anello semplice due vie  
Single branch body

CODICE	ØD	G*		H	L	L2	
T13B04M5	4	M5		10	19,5	19	50
T13B0618	6	1/8		15	24,3	23	50
T13B0814	8	1/4		17	26,5	27	50
T13B1038	10	3/8		20	29,9	34	25
T13B1212	12	1/2		24	34,9	40	10

(\*) G = filetto vite/asta  
(\*) G = steam thread  
H = altezza sede asta - H = stem site lenght

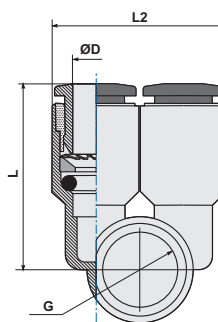

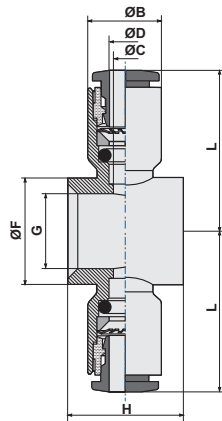



ART. T14 Anello doppio  
Double banjo body

CODICE	ØD	G*	ØC	ØB	H	ØF	L	
T1404M5	4	M5	3	9,5	10	8,0	19,5	50
T140418	4	1/8	3	9,5	15	14,0	21,1	50
T140618	6	1/8	5	11,5	15	14,0	24,3	50
T140614	6	1/4	5	11,5	17	18,0	25,5	50
T140818	8	1/8	7	13,5	15	14,0	24,8	50
T140814	8	1/4	7	13,5	17	18,0	26,5	50
T140838	8	3/8	7	13,5	20	21,3	28,0	25
T141014	10	1/4	9	17,0	17	18,0	28,4	50
T141038	10	3/8	9	17,0	20	21,3	29,9	25
T141012	10	1/2	9	17,0	24	26,0	30,0	10
T141238	12	3/8	10	20,0	20	21,3	31,4	25
T141212	12	1/2	10	20,0	24	26,0	34,9	10

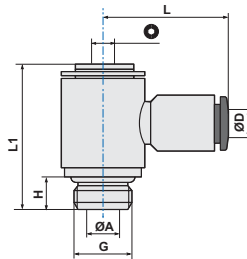
(\*) G = filetto vite/asta  
(\*) G = steam thread



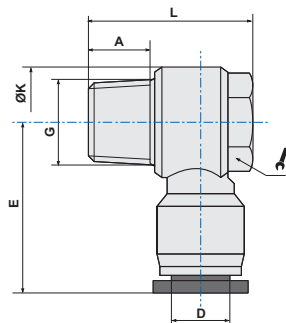

ART. T15 Anello semplice girevole con asta  
Complete single banjo (rotating under pressure)

CODICE	ØD	G	ØA	H	L1	L	Ø	
T1504M5	4	M5	2,0	4,0	17,8	19,5	2,5	50
T1504M6	4	M6	2,0	5,0	18,9	19,5	2,5	50
T150418	4	1/8	5,5	5,5	24,5	21,1	3,0	50
T150618	6	1/8	5,5	5,5	24,5	24,3	3,0	50
T150614	6	1/4	7,8	6,5	28,0	25,5	4,0	50
T150818	8	1/8	5,5	5,5	24,5	24,8	3,0	50
T150814	8	1/4	7,8	6,5	28,0	26,5	4,0	50
T150838	8	3/8	10,0	7,5	32,5	28,0	5,0	25
T151014	10	1/4	7,8	6,5	28,0	28,4	4,0	25
T151038	10	3/8	10,0	7,5	32,5	29,9	5,0	25
T151012	10	1/2	12,0	9,0	38,8	30,0	8,0	10
T151238	12	3/8	10,0	7,5	32,5	31,4	5,0	25
T151212	12	1/2	12,0	9,0	38,8	34,9	8,0	10



ART. T15C Anello semplice girevole con asta conico  
Complete single banjo tapered

CODICE	ØD	G	A	L	ØK	E		
T15C0418	4	1/8	7,5	23,0	14,4	23,5	12	50
T15C0618	6	1/8	7,5	23,0	14,4	24,0	12	50
T15C0614	6	1/4	9,5	26,5	18,3	25,4	14	50
T15C0638	6	3/8	10,5	32,0	22,0	29,5	19	25
T15C0818	8	1/8	7,5	23,0	14,4	28,9	14	50
T15C0814	8	1/4	9,5	26,5	18,3	29,1	14	50
T15C0838	8	3/8	10,5	32,0	22,0	30,0	19	25
T15C1014	10	1/4	9,5	26,5	18,3	33,0	14	25
T15C1038	10	3/8	10,5	32,0	22,0	33,5	19	25
T15C1012	10	1/2	13,5	38,5	28,0	36,5	24	10
T15C1238	12	3/8	10,5	32,0	22,0	35,8	19	10
T15C1212	12	1/2	13,5	38,5	28,0	36,8	24	10

ART. **T15FC** Anello semplice girevole con asta femmina conico  
Female complete single banjo tapered

CODICE	ØD	G/G1	L1	A1	B	ØK		
T15FC0418	4	1/8	23,5	7,5	29,0	14,4	14	50
T15FC0618	6	1/8	24,0	7,5	29,0	14,4	14	50
T15FC0614	6	1/4	25,4	9,5	35,0	18,3	17	50
T15FC0818	8	1/8	26,5	7,5	29,0	14,4	14	50
T15FC0814	8	1/4	28,9	9,5	35,0	18,3	17	50
T15FC0838	8	3/8	30,0	10,5	40,0	22,0	21	25
T15FC1014	10	1/4	33,0	9,5	35,0	22,0	21	25
T15FC1038	10	3/8	33,5	10,5	40,0	28,0	24	25
T15FC1012	10	1/2	36,5	13,5	47,5	18,3	17	10
T15FC1238	12	3/8	35,5	10,5	40,0	22,0	21	10
T15FC1212	12	1/2	36,5	13,5	47,5	28,0	24	10

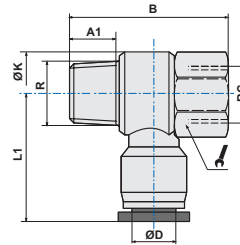

ART. **T15B** Anello due vie girevole con asta  
Single branch universal male elbow

CODICE	ØD	G	ØA	H	L1	L	Ø	
T15B04M5	4	M5	2,0	4,0	17,8	19,5	2,5	50
T15B0618	6	1/8	5,5	5,5	24,5	24,3	3,0	50
T15B0814	8	1/4	7,8	6,5	28,0	26,5	4,0	50
T15B1038	10	3/8	10,0	7,5	32,5	29,9	5,0	25
T15B1212	12	1/2	12,0	9,0	38,8	34,9	8,0	10

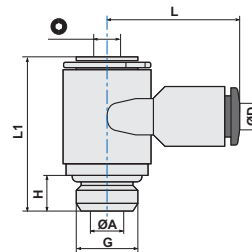

ART. **T16** Anello doppio girevole con asta  
Complete double banjo (rotating under pressure)

CODICE	ØD	G	ØA	H	L1	L	Ø	
T1604M5	4	M5	2,0	4,0	17,8	19,5	2,5	50
T160418	4	1/8	5,5	5,5	24,5	21,1	3,0	50
T160618	6	1/8	5,5	5,5	24,5	24,3	3,0	50
T160614	6	1/4	7,8	6,5	28,0	25,5	4,0	50
T160818	8	1/8	5,5	5,5	24,5	24,8	3,0	50
T160814	8	1/4	7,8	6,5	28,0	26,5	4,0	25
T160838	8	3/8	10,0	7,5	32,5	28,0	5,0	25
T161014	10	1/4	7,8	6,5	28,0	28,4	4,0	25
T161038	10	3/8	10,0	7,5	32,5	29,9	5,0	25
T161012	10	1/2	12,0	9,0	38,8	30,0	8,0	10
T161238	12	3/8	10,0	7,5	32,5	31,4	5,0	25
T161212	12	1/2	12,0	9,0	38,8	34,9	8,0	10

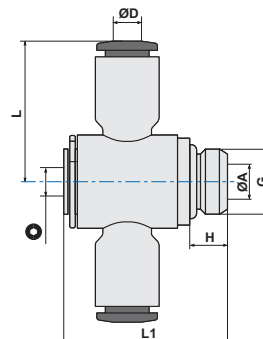



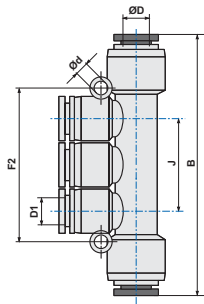



**ART. T18**

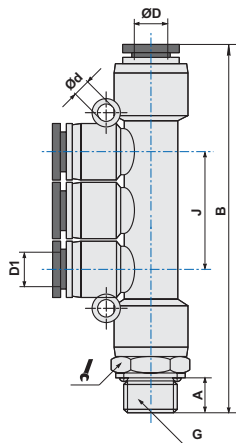

Giunzione tripla intermedia  
Triple branch union

CODICE	ØD	ØD1	J	B	Ød	F2		
T180604	6	4	22	58,0	3,2	36	25	
T180804	8	4	26	63,4	3,2	42	20	
T180806	8	6	26	63,4	3,2	42	20	
T181006	10	6	29	83,8	4,2	48	10	
T181008	10	8	29	83,6	4,2	48	10	



**ART. T18G**

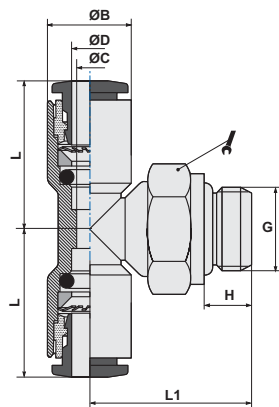

Giunzione tripla filettata  
Male triple branch

CODICE	ØD	D1	G	A	B	J		Ød	
T18G0418	4	4	1/8	5,5	68,0	26	14	3,2	25
T18G0414	4	4	1/4	7,5	70,0	26	17	3,2	25
T18G0438	4	4	3/8	7,5	70,0	26	20	3,2	10
T18G0618	6	6	1/8	5,5	68,0	26	14	3,2	25
T18G0614	6	6	1/4	7,5	70,0	26	17	3,2	25
T18G0638	6	6	3/8	7,5	70,5	26	20	3,2	10
T18G0612	6	6	1/2	10	73,0	26	24	3,2	10
T18G0818	8	8	1/8	5,5	87,0	29	14	3,2	20
T18G0814	8	8	1/4	7,5	89,0	29	17	3,2	20
T18G0838	8	8	3/8	7,5	89,5	29	20	3,2	10
T18G0812	8	8	1/2	10	92,5	29	24	3,2	10
T18G1018	10	10	1/8	5,5	95,5	37	14	4,2	10
T18G1014	10	10	1/4	7,5	98,0	37	17	4,2	10
T18G1038	10	10	3/8	7,5	98,5	37	20	4,2	10
T18G1012	10	10	1/2	10	101,5	37	24	4,2	10





**ART. T20**

Raccordo a T centrale girevole  
Swivel male stud tee parallel



CODICE	ØD	G	ØB	H	L	L1		
T2004M5	4	M5	9,5	4,0	17,2	17,0	8	50
T200418	4	1/8	9,5	5,5	17,2	18,5	13	50
T200414	4	1/4	9,5	7,5	17,2	20,4	16	50
T200438	4	3/8	11,0	7,5	19,0	27,3	20	25
T2006M5	6	M5	9,5	4,0	20,8	17,0	8	50
T200618	6	1/8	11,5	5,5	20,8	18,5	13	50
T200614	6	1/4	11,5	7,5	20,8	20,4	16	50
T200638	6	3/8	13,0	7,5	19,5	27,5	20	25
T200612	6	1/2	13,0	10	19,5	30,0	24	10
T200818	8	1/8	13,5	5,5	23,0	20,0	13	50
T200814	8	1/4	13,5	6,5	23,0	20,4	16	50
T200838	8	3/8	13,5	7,5	23,0	24,8	18	25
T200812	8	1/2	15,0	10	22,5	32,5	24	10
T201018	10	1/8	19,0	5,5	28,5	32,3	17	25
T201014	10	1/4	17,0	7,5	26,4	23,2	16	25
T201038	10	3/8	19,0	10,5	28,5	38,0	17	25
T201012	10	1/2	17,0	9	26,4	31,1	21	10
T201218	12	1/8	21,5	5,5	29,5	33,5	27	20
T201214	12	1/4	21,5	7,5	29,5	36,0	21	10
T201238	12	3/8	20,0	7,5	28,9	26,3	18	25
T201212	12	20	20,0	11	28,9	29,3	21	10

ART. T21 Raccordo a T laterale girevole  
Swivel male branch tee parallel

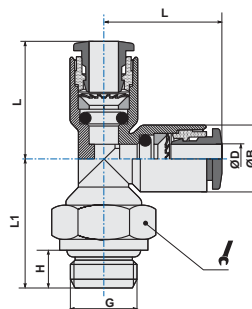
CODICE	ØD	G	ØB	H	L	L1		
T2104M5	4	M5	9,5	4	12,2	17,0	8	50
T210418	4	1/8	9,5	5,5	17,2	18,5	13	50
T210414	4	1/4	9,5	7,5	17,2	20,4	16	50
T210438	4	3/8	11,0	7,5	19	27,3	20	25
T2106M5	6	M5	9,5	4	20,8	17	8	50
T210618	6	1/8	11,5	5,5	20,8	18,5	13	50
T210614	6	1/4	11,5	7,5	20,8	20,4	16	50
T210638	6	3/8	13,0	7,5	19,7	27,5	20	25
T210612	6	1/2	13,0	10	19,7	30	24	10
T210818	8	1/8	13,5	5,5	23	20	13	50
T210814	8	1/4	13,5	7,5	23	20,4	16	50
T210838	8	3/8	13,5	9	23	24,8	18	25
T210812	8	1/2	14,4	9	22,5	32,5	24	10
T211018	10	1/8	19,0	5,5	27,8	32,5	17	25
T211014	10	1/4	17,0	6,5	26,4	23,2	16	25
T211038	10	3/8	19,0	7,5	28,5	38,5	17	25
T211012	10	1/2	17,0	10	26,4	31,1	21	10
T211218	12	1/8	21,0	5,5	29,5	33,5	21	25
T211214	12	1/4	21,0	7,5	29,5	36	21	10
T211238	12	3/8	20,0	7,5	28,9	26,3	18	25
T211212	12	1/2	20,0	9	28,9	31,1	21	10



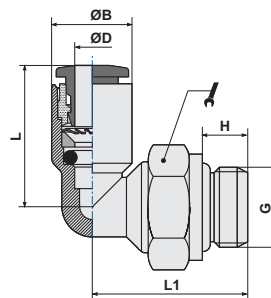

ART. T22 Gomito girevole filetto cilindrico maschio con O-Ring  
Swivel elbow male adaptor parallel

CODICE	ØD	G	ØB	H	L	L1		
T2204M5	4	M5	9,5	4	17,2	17	8	100
T220418	4	1/8	9,5	5,5	17,2	18,5	13	100
T220414	4	1/4	9,5	7,5	17,2	20,4	16	100
T2206M5	6	M5	11,5	4	20,8	17	8	100
T220618	6	1/8	11,5	5,5	20,8	18,5	13	100
T220614	6	1/4	11,5	7,5	20,8	20,4	16	100
T220818	8	1/8	13,5	5,5	23	20	13	100
T220814	8	1/4	13,5	7,5	23	20,4	16	100
T220838	8	3/8	13,5	7,5	23	24,8	18	50
T221018	10	1/8	19	5,5	27,8	26	14	50
T221014	10	1/4	17	7,5	26,4	23,2	16	50
T221038	10	3/8	17	7,5	26,4	24,8	18	50
T221012	10	1/2	17	9	26,4	31,1	21	25
T221214	12	1/4	20	6,5	28,9	24,2	16	50
T221238	12	3/8	20	7,5	28,9	26,3	18	50
T221212	12	1/2	20	9	28,9	31,1	21	25



ART. T22T Gomito girevole maschio in tecnopolimero con O-Ring  
Swivel elbow technopolymer male adaptor

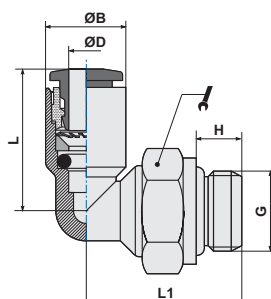

CODICE	ØD	G	ØB	H	L	L1		
T22T0418	4	1/8	9,5	5,5	17,2	18,5	14	100
T22T0414	4	1/4	9,5	6,5	17,2	20,4	16	100
T22T0618	6	1/8	11,5	5,5	20,8	18,5	14	100
T22T0614	6	1/4	11,5	6,5	20,8	20,4	16	100
T22T0818	8	1/8	13,5	5,5	23,0	20,0	14	100
T22T1014	10	1/4	17,0	6,5	26,4	23,2	16	50
T22T1214	12	1/4	20,0	6,5	28,9	24,2	16	50



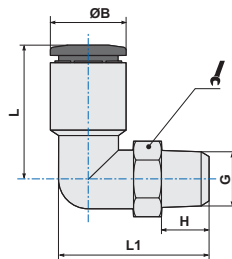



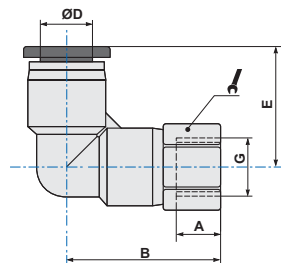

ART. T22C Gomito girevole filetto conico  
Swivel elbow male adaptor tapered

CODICE	ØD	G	ØB	H	L	L1		
T22C0418	4	1/8	9,5	8,0	17,2	19,2	13	100
T22C0414	4	1/4	11,5	9,5	18,5	26,8	14	100
T22C0438	4	3/8	11,5	10,5	19,0	28,3	17	25
T22C0618	6	1/8	11,5	8,0	20,8	19,2	13	100
T22C0614	6	1/4	11,5	11,0	20,8	22,2	14	100
T22C0638	6	3/8	13,5	10,5	19,2	28,2	17	25
T22C0612	6	1/2	13,5	13,5	19,2	31,7	21	10
T22C0818	8	1/8	13,5	8,0	23,0	21,5	13	100
T22C0814	8	1/4	13,5	11,0	23,0	23,4	14	100
T22C0838	8	3/8	14,5	10,5	23,0	31,0	17	50
T22C0812	8	1/2	14,5	13,5	23,0	26,2	21	10
T22C1018	10	1/8	18,5	7,5	27,8	33,8	17	50
T22C1014	10	1/4	18,5	9,5	27,8	34,3	17	50
T22C1038	10	3/8	17,0	11,5	17,0	27,3	17	50
T22C1012	10	1/2	18,5	13,5	27,8	38,8	21	25
T22C1218	12	1/8	21,5	7,5	29,5	33,5	21	25
T22C1214	12	1/4	21,5	9,5	29,5	36,0	21	50
T22C1238	12	3/8	20,0	11,5	20,0	28,8	17	50
T22C1212	12	1/2	21,5	13,5	29,5	40,0	21	25



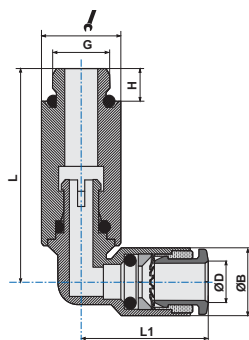

ART. T22F Gomito girevole femmina  
Female swivel elbow adaptor

CODICE	ØD	G	A	B	E		
T22F04M5	4	M5	5,5	20,5	19,0	10	50
T22F0418	4	1/8	8,5	24,0	19,0	14	50
T22F0414	4	1/4	11,0	27,0	19,0	17	50
T22F06M5	6	M5	6,0	20,7	19,2	12	50
T22F0618	6	1/8	8,5	24,2	19,2	14	50
T22F0614	6	1/4	11,0	27,2	19,2	17	50
T22F0638	6	3/8	12,0	28,7	19,2	21	25
T22F0818	8	1/8	8,0	27,0	23,0	14	50
T22F0814	8	1/4	11,0	30,5	23,0	17	50
T22F0838	8	3/8	12,0	32,0	23,0	21	25
T22F1014	10	1/4	11,0	34,3	28,2	17	25
T22F1038	10	3/8	12,0	35,8	28,2	21	25
T22F1012	10	1/2	14,0	38,8	28,2	24	10
T22F1214	12	1/4	11,0	37,0	29,5	21	25
T22F1238	12	3/8	12,0	38,0	29,5	21	25
T22F1212	12	1/2	14,0	40,5	29,5	24	10



ART. T22L Gomito girevole lungo  
Swivel longer elbow male adaptor

CODICE	ØD	G	ØB	H	L	L1		
T22L04M5	4	M5	11,0	3,5	34,5	19,0	10	25
T22L06M5	6	M5	13,0	3,5	36,4	19,2	10	25
T22L0418	4	1/8	9,5	6,0	35,7	17,2	13	25
T22L0618	6	1/8	11,5	6,0	35,7	20,8	13	25
T22L0818	8	1/8	13,5	6,0	38,0	23,0	13	25
T22L0814	8	1/4	13,5	8,0	43,9	23,0	16	25

ART. T22LC Gomito girevole conico lungo  
Swivel longer elbow male adaptor tapered

CODICE	ØD	G	A	B	ØC	E		
T22LC0418	4	1/8	7,5	37,0	11,0	19,0	10	25
T22LC0414	4	1/4	9,5	40,0	11,0	19,0	14	25
T22LC0618	6	1/8	7,5	39,7	13,0	19,2	12	25
T22LC0614	6	1/4	9,5	42,2	13,0	19,2	14	25
T22LC0638	6	3/8	10,5	43,7	13,0	19,2	17	25
T22LC0818	8	1/8	7,5	44,8	14,4	23,0	14	25
T22LC0814	8	1/4	9,5	46,8	14,4	23,0	17	25
T22LC0838	8	3/8	10,5	48,5	14,4	23,0	17	25
T22LC1018	10	1/8	7,5	54,3	18,5	28,2	17	25
T22LC1014	10	1/4	9,5	56,3	18,5	28,2	17	25
T22LC1038	10	3/8	10,5	57,3	18,5	28,2	17	25
T22LC1012	10	1/2	13,5	60,8	18,5	28,2	21	10
T22LC1214	12	1/4	9,5	61,5	21,0	29,5	21	10
T22LC1238	12	3/8	10,5	62,5	21,0	29,5	21	10
T22LC1212	12	1/2	13,5	65,5	21,0	29,5	21	10

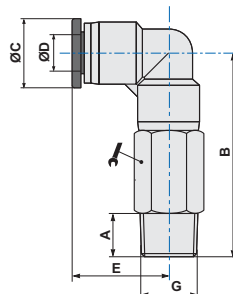

ART. T23 Y innestabile  
Y connector

CODICE	ØD1	ØD2	ØE	ØB	A	L	
T230400	4	4	2,40	9,5	19	33,0	50
T230406	4	6	2,40	11,5	19	35,8	50
T230600	6	6	2,60	11,5	23	38,6	50
T230608	6	8	3,20	13,5	23	39,8	50
T230800	8	8	2,75	16,5	27	42,5	50
T230810	8	10	3,20	17,0	27	44,4	25
T231000	10	10	4,30	20,0	34	50,8	25
T231012	10	12	4,30	20,0	34	50,8	25
T231200	12	12	4,20	20,0	40	53,2	25

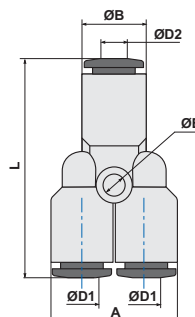

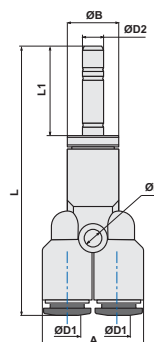

ART. T23LO Y innestabile  
Y connector

CODICE	ØD1	ØD2	ØB	A	ØE	L	L1	
T2304L0	4	4	9,5	19	2,40	50,0	16,7	50
T2306L0	6	6	11,5	23	2,60	58,1	19,5	50
T2308L0	8	8	13,5	27	2,75	63,5	21,0	50
T2310L0	10	10	17,0	34	4,30	74,8	24,0	25
T2312L0	12	12	20,0	40	4,20	78,2	25,0	20

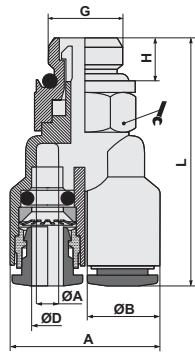



ART. **T23G** Y innestabile filetto cilindrico con O-Ring  
Y connector with swivel parallel male adapter

CODICE	ØD	G	ØA	ØB	H	C	L		
T23G04M5	4	M5	2,0	9,5	4,0	19,0	39,1	9	50
T23G0418	4	1/8	3,0	9,5	5,5	19,0	20,5	13	50
T23G0414	4	1/4	3,0	11,0	7,5	22,0	45,5	17	50
T23G0438	4	3/8	3,0	11,0	7,5	22,0	46,0	20	25
T23G0618	6	1/8	5,0	11,5	5,5	23,0	34,8	13	50
T23G0614	6	1/4	5,0	11,5	6,5	23,0	36,4	16	50
T23G0638	6	3/8	5,0	13,0	7,5	26,0	47,2	20	25
T23G0818	8	1/8	7,0	13,5	5,5	27,0	37,5	13	50
T23G0814	8	1/4	7,0	13,5	6,5	27,0	38,6	16	50
T23G0838	8	3/8	6,2	14,4	7,5	29,4	50,5	20	25
T23G1014	10	1/4	8,2	18,4	7,5	36,4	58,9	17	25
T23G1038	10	3/8	8,2	18,4	7,5	36,4	58,9	20	25
T23G1012	10	1/2	8,2	18,4	10	36,4	62,4	24	10
T23G1214	12	1/4	9,5	21,0	7,5	42,0	62,3	21	10
T23G1238	12	3/8	9,5	21,0	7,5	42,0	62,3	21	10
T23G1212	12	1/2	9,5	21,0	10	42,0	65,3	24	10

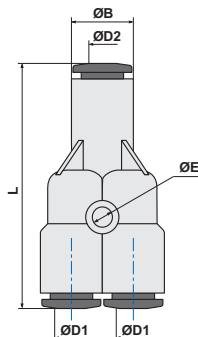

ART. **T24** Y doppio innestabile  
Double Y connector

CODICE	ØD1	ØD2	ØE	ØB	L	
T240400	4	4	3,2	9,5	34,5	25
T240406	4	6	3,2	11,5	36,8	25
T240408	4	8	3,2	13,5	36,8	25
T240600	6	6	3,2	11,5	39,6	25
T240608	6	8	3,2	13,5	41,8	25
T240800	8	8	3,5	15,0	42,0	25
T240810	8	10	3,2	17,0	46,5	25

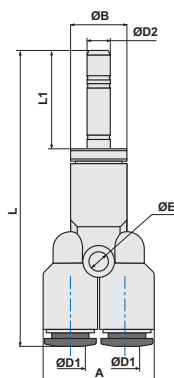

ART. **T24L0** Y doppio innestabile  
Double Y connector

CODICE	ØD1	ØD2	ØE	ØB	A	L	L1	
T2404L0	4	4	2,40	9,5	19	51,2	16,7	25
T2406L0	6	6	2,60	11,5	23	59,1	19,5	25
T2408L0	8	8	2,75	13,5	27	67,5	21,0	25

ART. T28 Regolatore di flusso unidirezionale per valvola  
Unidirectional flow regulator for valve

CODICE	ØD	G	ØA	H	L1	L		
T2804M5	4	M5	2,0	4	19,0	22,5	8	25
T280418	4	1/8	5,0	5,5	21,1	34,0	14	25
T2806M5	6	M5	2,0	4	22,0	22,5	8	25
T280618	6	1/8	5,0	5,5	24,3	34,0	14	25
T280614	6	1/4	6,0	6,5	25,5	42,0	17	25
T280818	8	1/8	5,0	5,5	24,8	34,0	14	25
T280814	8	1/4	6,0	6,5	26,5	42,0	17	25
T280838	8	3/8	6,5	7,5	28,0	52,0	20	10
T281014	10	1/4	6,0	6,5	28,4	42,0	17	25
T281038	10	3/8	6,5	7,5	29,9	52,0	20	10
T281238	12	3/8	6,5	7,5	31,4	52,0	20	10

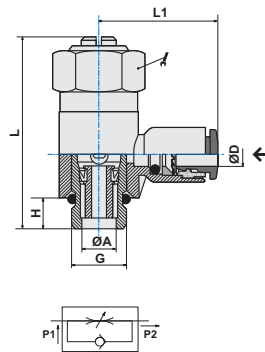

ART. T29 Regolatore di flusso unidirezionale per cilindro  
Unidirectional flow regulator for cylinder

CODICE	ØD	G	ØA	H	L1	L		
T2904M5	4	M5	2,0	4	19,0	22,5	8	25
T290418	4	1/8	5,0	4	21,1	34,0	14	25
T2906M5	6	M5	2,0	4	22,0	22,5	8	25
T290618	6	1/8	5,0	5,5	24,3	34,0	14	25
T290614	6	1/4	6,0	6,5	25,5	42,0	17	25
T290818	8	1/8	5,0	5,5	24,8	34,0	14	25
T290814	8	1/4	6,0	6,5	26,5	42,0	17	25
T290838	8	3/8	6,5	7,5	28,0	52,0	20	10
T291014	10	1/4	6,0	6,5	28,4	42,0	17	25
T291038	10	3/8	6,5	7,5	29,9	52,0	20	10
T291238	12	3/8	6,5	7,5	31,4	52,0	20	10
T291212	12	1/2	10,0	9	34,9	61,0	26	10

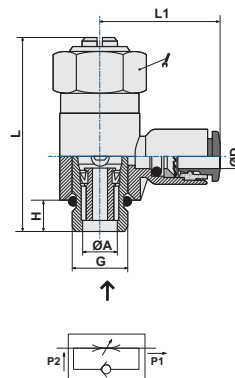

ART. T30 Regolatore di flusso bidirezionale  
Bidirectional flow regulator

CODICE	ØD	G	ØA	H	L1	L		
T3004M5	4	M5	2,0	4	19,0	22,5	8	25
T300418	4	1/8	5,0	4	21,1	34,0	14	25
T3006M5	6	M5	2,0	4	22,0	22,5	8	5
T300618	6	1/8	5,0	5,5	24,3	34,0	14	25
T300614	6	1/4	6,0	6,5	25,5	42,0	17	25
T300818	8	1/8	5,0	5,5	24,8	34,0	14	25
T300814	8	1/4	6,0	6,5	26,5	42,0	17	25
T300838	8	3/8	6,5	7,5	28,0	52,0	20	10
T301014	10	1/4	6,0	6,5	28,4	42,0	17	25
T301038	10	3/8	6,5	7,5	29,9	52,0	20	10
T301238	12	3/8	6,5	7,5	31,4	52,0	20	10
T301212	12	1/2	10,0	9	34,9	61,0	26	10

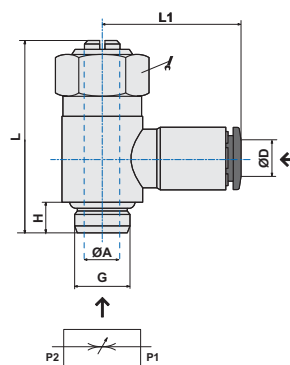

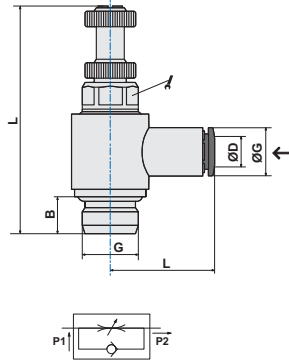

ART. T28P Regolatore di flusso unidirezionale per valvola  
Unidirectional flow regulator for valve

CODICE	ØD	G	B	L	L1			
T2804M5P	4	M5	4	34	19,0			8,0 25
T280418P	4	1/8	5,5	43	21,1			9,0 25
T2806M5P	6	M5	4	34	22,0			8,0 25
T280618P	6	1/8	5,5	43	24,3			9,0 25
T280614P	6	1/4	6,5	50	25,5			12,0 25
T280638P	6	3/8	9,5	53	29,5			13,0 10
T280612P	6	1/2	12,0	61	30,2			13,0 10
T280818P	8	1/8	5,5	43	24,8			9,0 25
T280814P	8	1/4	6,5	50	26,5			12,0 25
T280838P	8	3/8	9,5	53	30,0			14,4 10
T280812P	8	1/2	1,2	61	35,8			14,4 10
T281018P	10	1/8	6,5	42	30,7			18,4 10
T281014P	10	1/4	6,5	50	28,4			12,0 25
T281038P	10	3/8	9,5	53	33,5			18,4 10
T281012P	10	1/2	12,0	61	36,5			18,4 10
T281214P	12	1/4	8,5	48	33,7			21,0 10
T281238P	12	3/8	9,5	53	35,5			19,0 10
T281212P	12	1/2	12,0	61	36,5			21,0 10

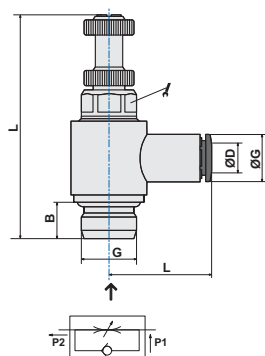

ART. T29P Regolatore di flusso unidirezionale per cilindro  
Unidirectional flow regulator for cylinder

CODICE	ØD	G	B	L	L1			
T2904M5P	4	M5	4	34	15,0			8,0 25
T290418P	4	1/8	5,5	43	21,1			9,0 25
T2906M5P	6	M5	4	34	22,0			8,0 25
T290618P	6	1/8	5,5	43	24,3			9,0 25
T290614P	6	1/4	6,5	50	25,5			12,0 25
T290638P	6	3/8	9,5	53	29,5			13,0 10
T290612P	6	1/2	12,0	61	30,2			13,0 10
T290818P	8	1/8	5,5	43	24,8			9,0 25
T290814P	8	1/4	6,5	50	26,5			12,0 25
T290838P	8	3/8	9,5	53	30,0			14,4 10
T290812P	8	1/2	1,2	61	35,8			14,4 10
T291018P	10	1/8	6,5	42	30,7			18,4 10
T291014P	10	1/4	6,5	50	28,4			12,0 25
T291038P	10	3/8	9,5	53	33,5			18,4 10
T291012P	10	1/2	12,0	61	36,5			18,4 10
T291214P	12	1/4	8,5	48	33,7			21,0 10
T291238P	12	3/8	9,5	53	35,5			19,0 10
T291212P	12	1/2	12,0	61	36,5			21,0 10

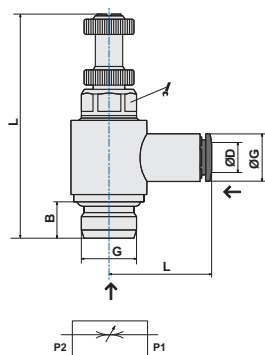

ART. T30P Regolatore di flusso bidirezionale  
Bidirectional flow regulator

CODICE	ØD	G	B	L	L1			
T3004M5P	4	M5	4	34	19,0			8 25
T300418P	4	1/8	5,5	43	21,1			9 25
T3006M5P	6	M5	4	34	22,0			8 25
T300618P	6	1/8	5,5	43	24,3			9 25
T300614P	6	1/4	6,5	50	25,5			12 25
T300818P	8	1/8	5,5	43	24,8			9 25
T300814P	8	1/4	6,5	50	26,5			12 25
T301014P	10	1/4	6,5	50	28,4			12 25

ART. **T31** Regolatore di flusso in linea  
Flat flow regulator

CODICE	ØD	B	G	F	S	Ød	J	
T310400	4	40,5	14,4	6,5	6,5	3,2	14	25
T310600	6	48,7	25,3	8,5	11,0	4,3	20	25
T310800	8	54,4	25,1	9,5	12,0	4,3	22	25
T311000	10	64,3	28,8	10,5	12,5	4,3	26	10
T311200	12	74,6	26,1	13,0	16,0	4,3	32	10

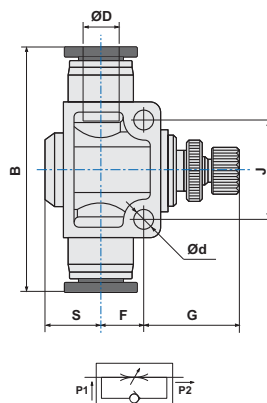

ART. **T33** Doppio anello semplice girevole con asta  
Swivel double banjo stem

CODICE	ØD	G	ØA	H	L1	L	Ø		
T330418	4	1/8	5,5	5,5	43,3	21,1	3	14	25
T330618	6	1/8	5,5	5,5	43,3	24,3	3	14	25
T330614	6	1/4	7,8	6,5	50,0	25,5	4	18	25
T330818	8	1/8	5,5	5,5	43,3	24,8	3	14	25
T330814	8	1/4	7,8	6,5	50,0	26,5	4	18	25
T331014	10	1/4	7,8	6,5	50,0	28,4	4	18	25

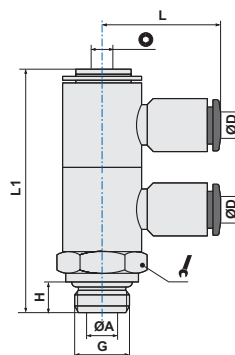

ART. **T33B** Doppio anello due vie girevole con asta  
Double branch universal male elbow

CODICE	ØD	G	ØA	H	L1	L	Ø		
T33B0618	6	1/8	5,5	5,5	43,3	24,3	3	14	10
T33B0814	8	1/4	7,8	6,5	50,0	26,5	4	18	10

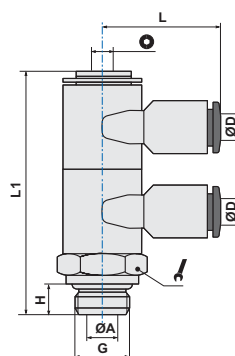



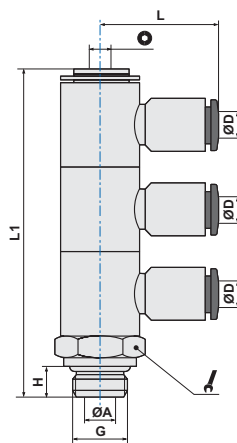

#### ART. T34

Triplo anello semplice girevole con asta  
Swivel triple banjo stem

CODICE	ØD	G	ØA	H	L1	L	Ø	🔧	📦
T340418	4	1/8	5,5	5,5	58	21,1	3	14	10
T340618	6	1/8	5,5	5,5	58	24,3	3	14	10
T340818	8	1/8	5,5	5,5	58	24,8	3	14	10
T340614	6	1/4	7,8	6,5	67	25,5	4	18	10
T340814	8	1/4	7,8	6,5	67	26,5	4	18	10
T341014	10	1/4	7,8	6,5	67	28,4	4	18	10

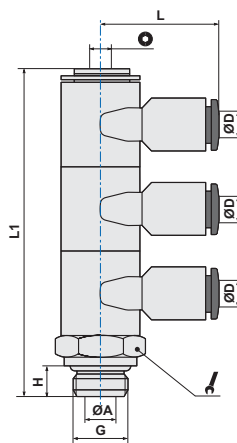

#### ART. T34B

Triplo anello due vie girevole con asta  
Triple branch universal male elbow

CODICE	ØD	G	ØA	H	L1	L	Ø	🔧	📦
T34B0618	6	1/8	5,5	5,5	58	24,3	3	14	10
T34B0814	8	1/4	7,8	6,5	67	26,5	4	18	10

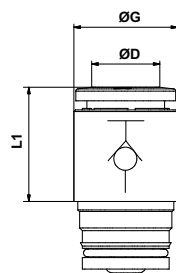

#### ART. TSTOP

Valvola di blocco  
Stop valve

CODICE	ØD	ØG	L1					📦
TSTOP04	4	9,5	11					10
TSTOP06	6	11,5	13					10
TSTOP08	8	13,5	15					10

Adattabile a tutti i raccordi della serie Tecno-RAP  
Suitable for all Tecno-RAP fitting series

**ART. 15A**

 Asta singola per anello girevole  
Single stem for swivel banjo

CODICE	G	L	ES.			
15AM5	M5	17	2,5			10
15AM5L	M5	18	2,5			10
15AM6	M6	18	2,5			10
15AM6L	M6	19	2,5			10
15A18	1/8	24,5	3			10
15A14	1/4	28	4			10
15A38	3/8	32,5	5			10
15A12	1/2	39	8			10

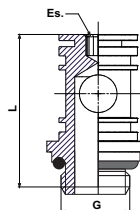
**ART. 33A**

 Asta doppia per anello girevole  
Double stem for swivel banjo

CODICE	G	L				
33AM5L	M5	28,0		N.C.	2,5	50
33A18	1/8	43,3		14	3	50
33A14	1/4	50,0		18	4	50

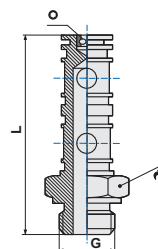
**ART. 34A**

 Asta tripla per anello girevole  
Triple stem for swivel banjo

CODICE	G	L				
34A18	1/8	58,4		14	3	50
34A14	1/4	67,1		18	4	25

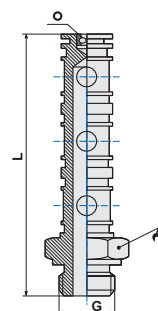
**ART. 28/29/30A**

 Asta regolatore orientabile  
Positioned flow regulator stem

CODICE	L max	ØB	H	G	ØA		
28/29/30AM5	24,0	6,0	4,0	M5	5,0	8,0	10
28/29/30A18	31,5	9,8	7,0	1/8	13,5	14,0	10
28/29/30A14	38,0	13,0	8,0	1/4	17,0	17,0	10
28/29/30A38	46,5	16,5	9,0	3/8	21,0	21,0	10

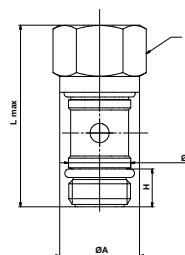
**ART. 28/29/30AP**

 Asta regolatore girevole  
Swivel flow regulator stem

CODICE	L max	ØB	H	G	ØA		
28/29/30AM5P	35,0	6,0	4,2	M5	5,0	8,0	10
28/29/30A18P	37,5	9,8	5,9	1/8	13,5	9,0	10
28/29/30A14P	44,0	13,0	7,0	1/4	17,0	12,0	10

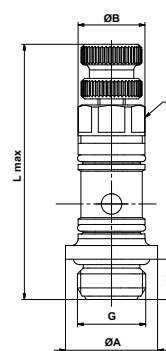

28 = per valvola (IN type)    29 = per cilindro (OUT type)    30 = bidirezionale (bi-directional)